

**PRODUCT
BROCHURE**

Link Chain/Lifting Chain
Truck/Forestry Tire Chain

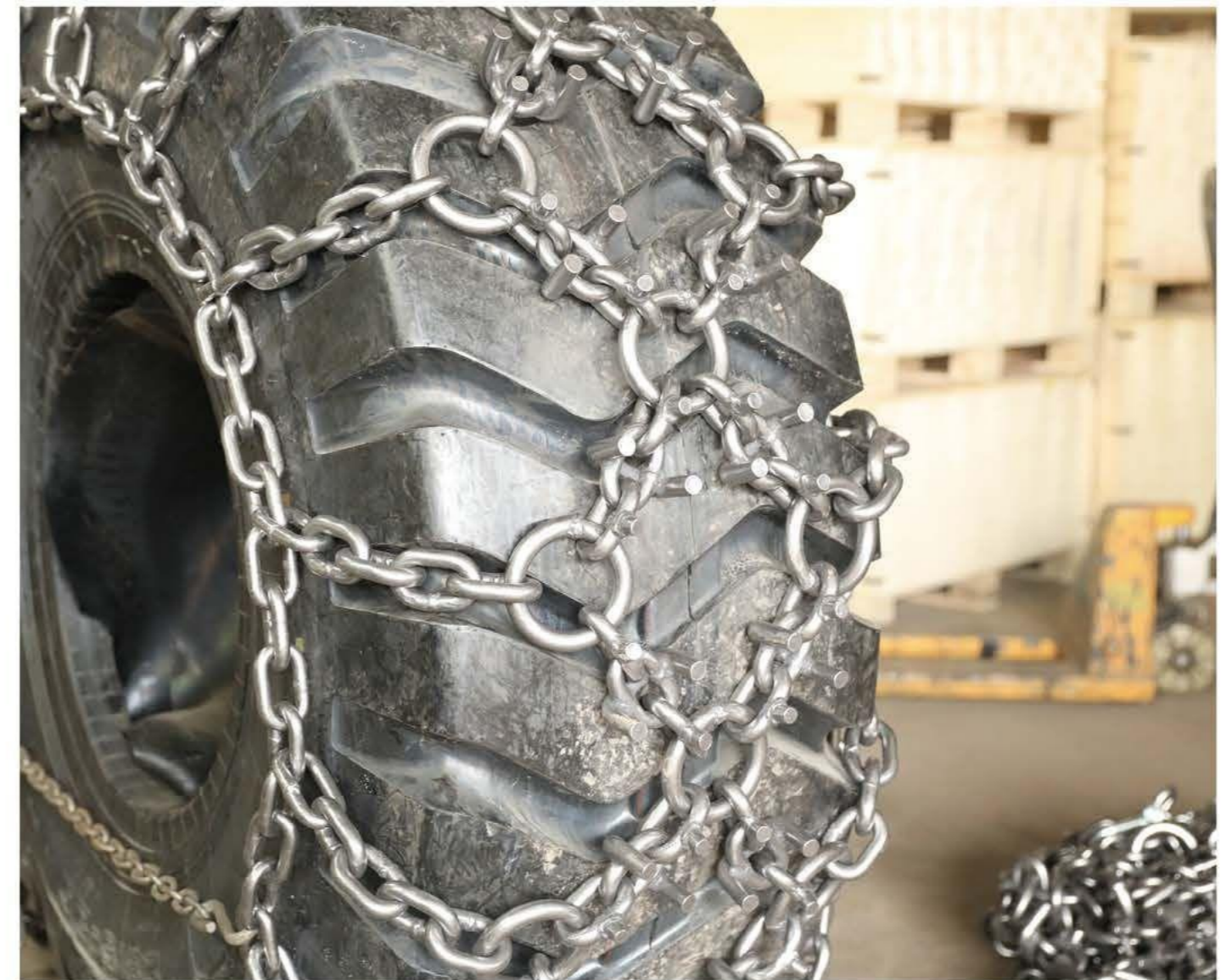



CONTENTS

The manufacturer established in 2005, is located in Xiaoshan Hangzhou and specializes in the field of manufacturing welded chains and a series of accessories. With the experience of being a chain manufacturer in this field for more than 10 years, we believe that we have a pretty mature production, marketing, and managing system. "Diligence, pragmatism, innovation, aggressiveness" is our company culture.

Our main products are high-strength chain, lifting chain, tie-down chain, binding chain, chain sling, car chain, truck chain, tractor chain, forestry chain etc. Our chains can be used in lifting, transportation, decoration and tire protection area.

Obtaining ISO9001 quality system and CE certificate issued by the State General Administration for Quality Supervision and Inspection Center, our company and products we believe will meet your satisfaction.

If you have interest in our products or any questions ,please do not hesitate to contact us.

- Lifting Chain 01
- G80 Chain Sling 02
- G80 Chain Fittings..... 05
- G100 Chain Fittings 09
- Link Chain 13
- Trailer Safety Chain 15
- Binder Chain 16
- Australian Chain 17
- Hooks 18
- Chain Disks 19
- Shackle 21
- Loadbinder 23
- Car Chains 25
- Truck Chains 29
- Graden Chains 35
- Truck Chains 36
- Tractor Chains 44
- Forestry Chains 48
- Forestry Parts 52

G80 ALLOY CHAIN FOR CHAIN SLING, EN 818-2

NOMINAL SIZE MM	MATERIAL DIAMETER TOLERANCE	PITCH			WIDTH		WLL T	PROOF FORCE kN	MIN. BREAKING LOAD kN
		MM	MAX. MM	Min. MM	INTERNAL MIN.	EXTERNAL MAX.			
6	+/-0.24	18	18.5	17.5	7.8	22.2	1.12	28.3	45.2
7	+/-0.28	21	21.6	20.4	9.1	25.9	1.5	38.5	61.6
8	+/-0.32	24	24.7	23.3	10.4	29.6	2	50.3	80.4
10	+/-0.4	30	30.9	29.1	13.0	37.0	3.15	78.5	126
13	+/-0.52	39	40.2	37.8	16.9	48.1	5.3	133	212
16	+/-0.64	48	49.4	46.6	20.8	59.2	8	201	322
18	+/-0.9	54	55.6	52.4	23.4	66.6	10	254	407
20	+/-1.0	60	61.8	58.2	26.0	74.0	12.5	314	403
22	+/-1.1	66	68.0	64.0	28.6	81.4	15	380	608
26	+/-1.3	78	80.3	75.7	33.8	96.2	21.2	531	849
32	+/-1.6	96	98.9	93.1	41.6	118.0	31.5	804	1290

G100 ALLOY CHAIN FOR CHAIN SLING,

SIZE (mm)	PITCH (mm)	I.W. (mm)	O.W. (mm)	WLL (T)	TEST LOAD (kN)
6	18	8.5	22.2	1.4	35.3
7	21	9.1	25.9	1.9	48.1
8	24	11	29.6	2.5	62.8
10	30	13.5	37	4	98.2
13	39	16.9	48.1	6.7	166
16	48	20.8	59.2	10	251
19	57	24.7	70.3	14	354
20	60	26	74	16	393
22	66	28.6	81.4	19	457
26	78	33.8	96.2	26.5	664
32	96	41.6	118	40	1005

WORKING LOAD LIMITS IN TONNES ACC. TO EN1677

For chain size mm	Ton	β 0 - 45° α 0 - 90°		β 0 - 45° α 0 - 90°		Choke endless sling
		45° - 60° 90° - 120°	45° - 60° 90° - 120°	3 legs	4 legs	
6	1.12	1.6	1.12	2.36	1.7	1.8
7	1.5	2.12	1.5	3.15	2.24	2.5
8	2.0	2.8	2.0	4.25	3.0	3.15
10	3.15	4.25	3.15	6.7	4.75	5.0
13	5.3	7.5	5.3	11.2	8.0	8.5
16	8.0	11.2	8.0	17.0	11.5	12.5
19	11.2	16.0	11.2	23.6	17.0	18.0
20	12.5	17.0	12.5	26.5	19.0	20.0
22	15.0	21.2	15.0	31.5	22.4	23.6
26	21.2	30.0	21.2	45.0	31.5	33.5
32	31.5	45.0	31.5	67.0	47.5	50.0

GRADE 80 CHAIN SLING

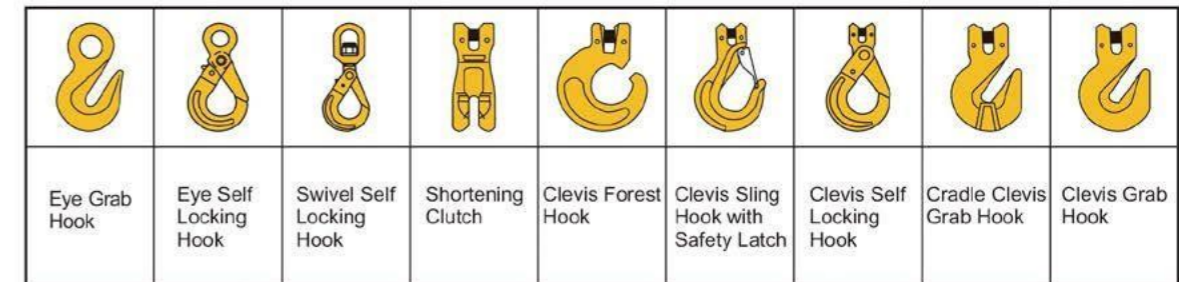
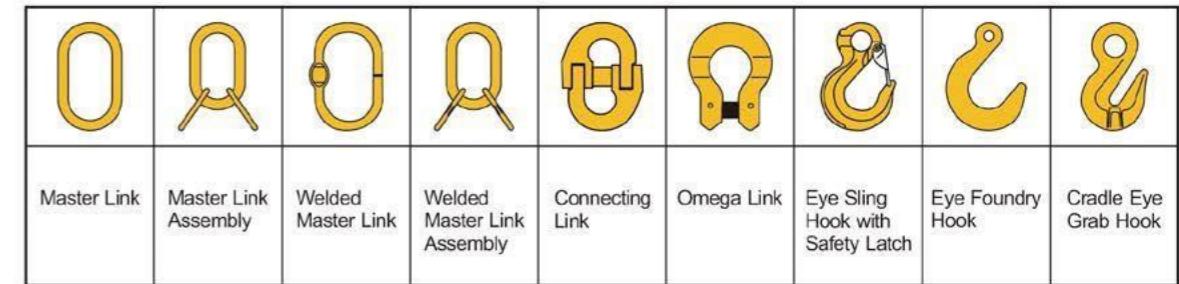

Chain Sling Selection

In this catalogue the maximum working load limit for each size of chain is shown. These ratings are based on ideal conditions, however in practice, working conditions may vary widely. All lifting applications should be assessed by a competent person in order to establish the size and type of sling required.

In the case of multi-leg slings, the angle between the legs is critical. The actual tension on each leg increases when the angle between the legs increases as shown in the diagram opposite. For this reason all general purpose chain slings are given a rating based upon use at 90° inc. angle. The included angle between the legs should never exceed 120°.

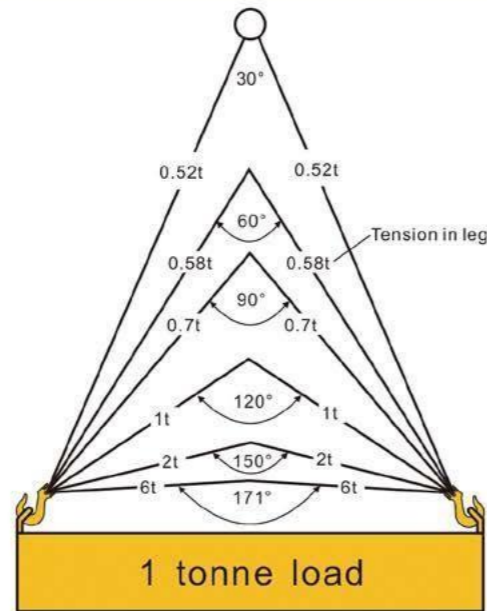

The distance between the crane hook and the load is known as the "Head Room". If a specific head room is required, the "Reach" of the chain sling must increase as the angle between the legs increases as shown opposite.

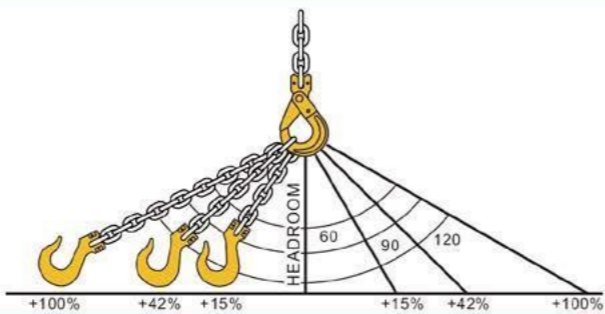

The reach of a chain sling is the distance between bearing points of the upper and lower terminal fittings. This distance, commonly known as the "Bearing to Bearing" should be quoted when ordering slings. Shortening clutches may be fitted to a sling, making the reach adjustable, hence increasing the versatility of the sling.



Unusual Applications

Recommended Load Factors for unusual slinging methods and conditions. Factor normally applied to W.L.L. of a Single Chain.

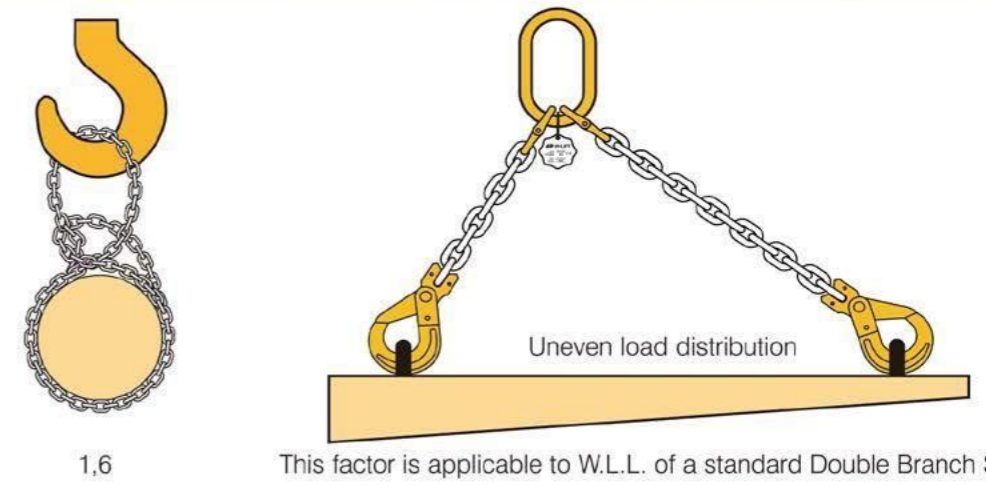

This factor is applicable to W.L.L. of a standard Double Branch Sling 0,7

Temperature loadings: Applicable to chain temperature

-40° to 200° C 1	200° C to 300° C 0,9	300° C to 400° C 0,75
---------------------	-------------------------	--------------------------

Edge loadings: Applicable to load lifting and load lashing

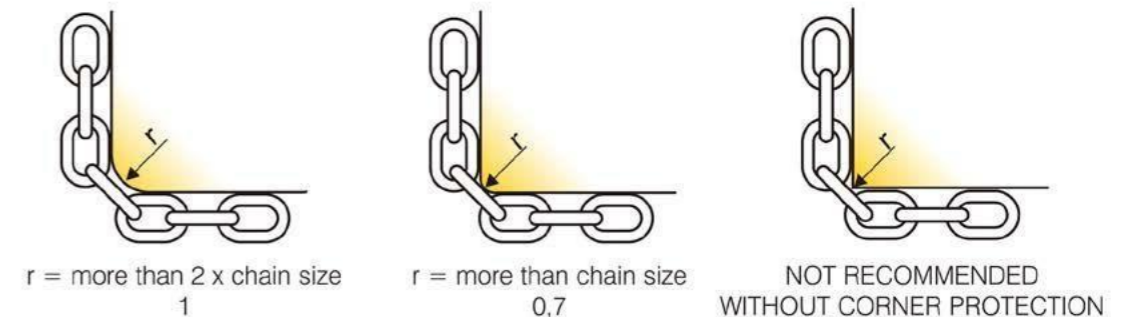

GRADE 80 CONNECTING LINK EUROPEAN TYPE

Chain Size mm	WLL ton	Main Dimensions (mm)				Weight kg
		A	L	K	D	
6	1.12	15	58	42	7	0.08
7	1.5	19	71.8	54.8	8.5	0.145
7+8	2	18	79.5	62.5	8.5	0.146
10	3.15	25	93	68	10.8	0.3
13	5.3	29	117	87	15	0.7
16	8	34.5	148	108.4	19.8	1.1
18	10	38	154	112	21	1.84
18+20	12.5	41	169.5	121.5	24	1.8
22	15	48	193.5	141.5	26	3.2
26	21.2	57.5	220	158	30	4.5
32	31.5	67	281	205	37	9

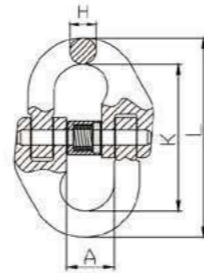

GRADE 80 EYE SLING HOOK WITH SAFETY LATCH

Chain Size mm	WLL ton	Main Dimensions (mm)					Weight kg
		D	E	φ	φ1	L	
6	1.12	9	24	21	20	108	0.3
7+8	2	11	30	26	25	133	0.4
10	3.15	15	34	39	38	167	0.9
13	5.3	19	39	54	43	213	1.7
16	8	23	46	64	50	255	3.2
20	12.5	24	40	80	62	305	5.8
22	15	32	71	80	62	348	8.5
26	21.2	35	81	82	64	394	13
32	31.5	37	102	112	88	480	17

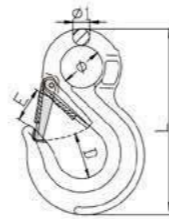

GRADE 80 CLEVIS SLING HOOK WITH SAFETY LATCH

Chain Size mm	WLL ton	Main Dimensions (mm)						Weight kg
		A	B	φ	H	K	E	
6	1.12	8	32	35	23	76	26	0.32
7+8	2	9.5	37	37	32.5	85.5	29	0.52
10	3.15	13	49	46	35	104	39	1.05
13	5.3	16.5	56.5	56	42.5	128	47	2
16	8	21.5	70.5	60	54	150	55	3.7
20	12.5	24	77	79	58	180	61	6
22	15	27	91	101	62	213	72	10.4
26	21.2	30	117	115	75	250	85	14.5
32	31.5	35	150	140	88	317	106	27

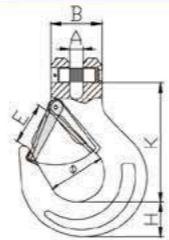

GRADE 80 EYE SELF LOCKING HOOK EUROPEAN TYPE

Chain Size mm	WLL ton	Main Dimensions (mm)						Weight kg
		φ1	R	D	φ	H	E	
6	1.12	22	110.5	10	34	19.5	28	0.5
7+8	2	25	136	12	46	24	34	0.8
10	3.15	32	171	15	56	28.5	44	1.55
13	5.3	40.5	208.5	19.5	69	40	52	3.2
16	8	56	257.5	22	86	50.5	60	5.74
20	12.5	64.5	275	27	100	55	81	8.5
22	15	70	320	30	98	67	82	13
26	21.2	80	363	34	110	75	110	18
32	31.5	105	472	45	166	97	168	45

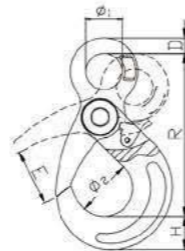

GRADE 80 CLEVIS SELF LOCKING HOOK EUROPEAN TYPE

Chain Size mm	WLL ton	Main Dimensions (mm)					Weight kg
		E	A	H	φ	L	
6	1.12	29	8.5	19.5	34	95.5	0.5
7+8	2	34	9.5	24	46	121	0.8
10	3.15	44	12	28.5	56	146	1.5
13	5.3	52	15	40	69	182	2.8
16	8	60	18	50.5	86	218	5.6
20	12.5	83	25	55	100	240	7.5
22	15	88	25.5	67	98	276.5	11.5
26	21.2	95.5	30	75	110	310.5	18.5
32	31.5	160	36	97	166	411.5	49.1

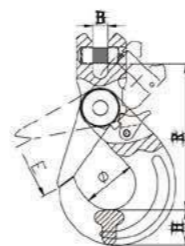

GRADE 80 SWIVEL SELF LOCKING HOOK EUROPEAN TYPE

Chain Size mm	WLL ton	Main Dimensions (mm)						Weight kg
		B	C	D	L	φ	E	
6	1.12	32.5	22	11.25	170	34	29	0.71
7+8	2	35.5	26	12.5	210	46	34	1.1
10	3.15	42	34	15	247	56	44	2
13	5.3	50	38.5	16	302	69	52	4
16	8	61	55	21.5	383	86	60	7.3
20	12.5	72	61	26	418	100	83	11.6
22	15	95	95	33	527	98	88	16
26	21.2	122	115	42	610	110	95.5	21.5
32	31.5	140	146	52	777	166	150	79

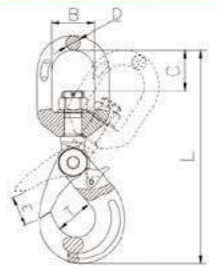

GRADE 80 SWIVEL SELF LOCKING HOOK WITH BEARING EUROPEAN TYPE

Chain Size mm	WLL ton	Main Dimensions (mm)						Weight kg
		B	C	D	L	T	E	
6	1.12	32.5	34.8	11.5	163	34	27	0.71
7+8	2	36	40	13	195	46	35	1.1
10	3.15	42	48	15.5	237	56	44	2
13	5.3	50	58	17	282	69	53	4
16	8	61	61	21.5	342	86	60	7.3
20	12.5	76	75.5	26.5	400	100	87	11.6
22	15	97	97	33	461	98	80	16
26	21.2	123	115	42	537	110	98	21.5

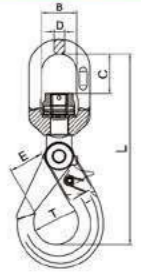

GRADE 80 CRADLE CLEVIS GRAB HOOK

Chain Size mm	WLL ton	Main Dimensions (mm)				Weight kg
		E	A	H	L	
6	1.12	8	8	16	75	0.25
7+8	2	10.8	9.5	21.6	90	0.32
10	3.15	13.5	12.5	30	126	0.73
13	5.3	16.5	15	42.5	163.5	1.6
16	8	19.2	19.5	45.5	183.5	2.8
20	12.5	24	24	56	219	5
22	15	27	27	68.5	254	6.3
26	21.2	30	30	77	309	14.5

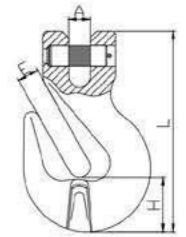

GRADE 80 CRADLE EYE GRAB HOOK

Chain Size mm	WLL ton	Main Dimensions (mm)					Weight kg
		E	φ	H	R	L	
6	1.12	8	13.5	16	51	75.2	0.14
7+8	2	10.8	17	18.5	60.5	88.5	0.245
10	3.15	13	20	29	79.5	121.5	0.65
13	5.3	16.5	26	42.8	99.7	158	1.39
16	8	19.2	30	45.7	104	169	2.2
20	12.5	24	37	56	140	219	4.6
22	15	28	44	68	165	259	8.2
26	21.2	30	41	77	188.5	298	9.8
32	31.5	38	57	95	228	361	19.4

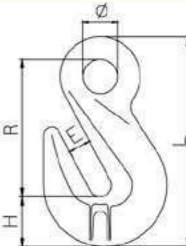

GRADE 80 NEW TYPE CLEVIS SHORTENING HOOK

Chain Size mm	WLL ton	Main Dimensions (mm)					Weight kg
		A	B	E	M	L	
6	1.12	8	32	8	43.5	75	0.28
7+8	2	9.5	35	11	49.5	89	0.33
10	3.15	12.5	42.5	13.2	70.5	126.5	0.88
13	5.3	15	53	16.5	90	163.5	1.85
16	8	19.5	65.5	19.2	112.5	183.5	3.24

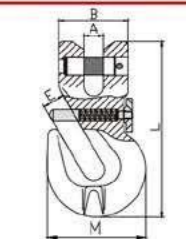

GRADE 80 NEW TYPE EYE SHORTENING HOOK

Chain Size mm	WLL ton	Main Dimensions (mm)					Weight kg
		φ	B	D	E	L	
6	1.12	8	17	9.5	11	88.5	0.29
10	3.15	12.5	20	13	13	121.5	0.75
13	5.3	21.2	26	15.5	16.5	158	1.62

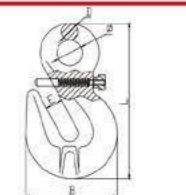

GRADE 80 EUROPEAN TYPE MASTER LINK



WLL ton	Main Dimensions (mm)			Weight kg
	A	B	D	
1.6	110	60	13	0.34
2.12	110	60	16	0.54
3.15	135	75	18	0.82
5.3	160	90	22	1.50
8	180	100	26	2.32
11.2	200	110	32	3.95
14	260	140	36	6.34
17	300	160	40	8.96
21.2	340	180	45	12.80
31.5	350	190	50	16.55
45	400	200	56	23.28
56	430	220	63	32.00
63	460	250	72	45.76

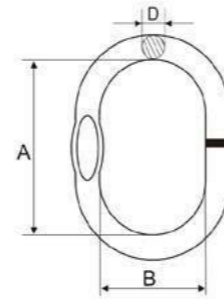

GRADE 80 U. S. TYPE MASTER LINK



Chain Size inch	WLL(T)		Main Dimensions (mm)			Weight kg
	1leg	2legs(0-45°)	A	B	D	
1/4	1.5	2.12	127	63.5	13	0.36
5/16	2	2.8				
5/16	2	2.8	152	76	16	0.7
3/8	3.15	/				
3/8	3.15	4.25	140	70	19	0.93
3/8	3.15	4.25	160	90	22	1.5
1/2	5.3	/				
1/2	5.3	7.5	178	89	25	2.1
5/8	8	11.2				
5/8	8	11.2	222	111	32	4.24
3/4	11.2	16				
3/4	11.2	16	267	135	38	7.17
7/8	15	21.2				
7/8	15	21.2	305	152	45	11.55
1	21.2	/				
1	21.2	30	355	178	51	17.2
1-1/4	31.5	/				
1-1/4	31.5	45	406	203	57	24.5
/	/	/	406	203	63.5	30.9
/	/	/	406	241	70	39.5
/	/	/	457	228	76	50.34
/	/	/	508	254	82.5	65.68
/	/	/	610	305	89	90.24
/	/	/	508	254	95	89.27
/	/	/	508	254	102	103.43

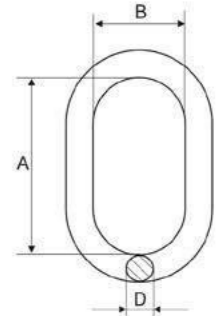

GRADE 80 EUROPEAN TYPE MASTER LINK ASSEMBLY



Chain Size mm	WLL ton	Main Dimensions (mm)						Weight kg
		A	B	D	a	b	d	
6	2.36	135	75	18	54	25	13	1.18
7	3.15	135	75	18	60	38	13	1.24
8	4.25	160	90	22	70	34	16	2.20
10	6.7	180	100	26	85	40	18	3.40
13	11.2	200	110	32	115	50	22	6.10
16	17	260	140	36	140	65	26	9.98
18	21.2	340	180	45	180	100	32	18.90
20	26.5	350	190	50	180	100	32	22.60
22	31.5	350	190	50	180	100	36	25.20
26	45	400	200	56	180	100	40	35.20
28	50	430	220	63	180	100	45	47.00
32	63	460	250	72	200	110	50	66.46

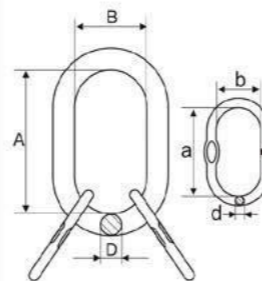

GRADE 80 U. S. TYPE MASTER LINK ASSEMBLY



Chain Size inch	WLL(T) 3or4leg(0-45°)	Main Dimensions (mm)						Weight kg
		A	B	D	a	b	d	
1/4	3.15	140	70	20	85	40	14	1.55
5/16	4.25							
5/16	4.25	160	95	22	85	40	14	2.18
3/8	6.7							
3/8	6.7	178	89	25	100	60	18	3.29
1/2	11.2	220	110	32	100	60	22	7.18
5/8	17							
5/8	17	267	135	38	180	100	30	12.91
3/4	23.6							
3/4	23.6	305	152	45	180	100	32	21.25
7/8	31.5							
7/8	31.5	356	178	50	180	100	38	30.34
1	45	406	203	64	355	178	51	64.4
1-1/4	67	406	241	70	406	203	57	89

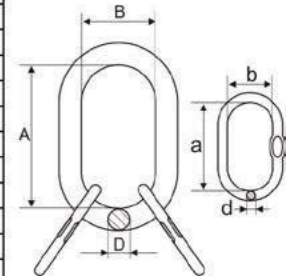

GRADE 80 U. S. TYPE WELDED MASTER LINK



Chain Size inch	WLL(T)			Main Dimensions (mm)			Weight kg
	1leg	2legs(0-45°)	ROPE	A	B	D	
1/4	1.12	1.6	1.6	100	60	12	0.27
9/32	1.5	/					
9/32	1.5	2.12	2.5	100	60	14	0.38
5/16	2	/					
5/16	2	2.8	4	160	90	18	0.85
3/8	3.15	/					
3/8	3.15	4.25	6.5	160	90	20	1.2
1/2	5.3	/					
1/2	5.3	7.5	8	180	100	22	1.63
5/8	8	/					
5/8	8	11.2	11.5	180	100	25	2.13
19mm	11.2	/					
3/4	12.5	/	11.8	270	140	28	3.81
19mm	11.2	16	16	270	140	32	5.05
7/8	15	/					
7/8	15	21.2	24	285	155	36	6.83
1	21.2	/					
28mm	25	/	25	300	160	40	8.9
1	21.2	30	31.5	340	180	45	12.8
1-1/4	31.5	/					
1-1/4	31.5	45	45	390	215	51	17.3

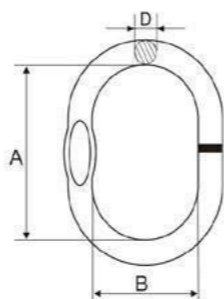

GRADE 80 U. S. TYPE WELDED MASTER LINK ASSEMBLY



Chain Size inch	WLL(T)		Main Dimensions (mm)							Weight kg
	3 or 4leg (0-45°)	ROPE	A	B	D	a	b	d	s	
7/32	2.36	2.4	100	60	14	85	40	12	6	0.82
1/4	3.15	3.2	160	90	18	100	60	14	7.6	1.60
5/16	4.25	4.2	160	90	20	100	60	14	7.6	1.95
3/8	6.7	8	180	100	22	150	70	18	8.4	3.16
1/2	11.2	12	270	140	28	160	90	22	13.5	6.75
5/8	17	17	270	140	32	180	100	25	16.5	9.31
3/4	23.6	25	300	160	40	270	140	31	19	18.40
7/8	31.5	31.5	340	180	45	285	155	36	22	26.60
1	45	45	350	190	51	340	180	45	25	42.91

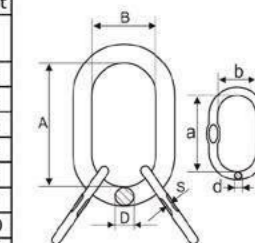

G100 EUROPEAN TYPE CONNECTING LINK



Chain Size	WLL	Main Dimensions (mm)					Weight
		H	A	K	L	kg	
mm	ton						
6	1.4	7.6	14	44.5	60	0.1	
8	2.5	10	18.5	61.5	84.5	0.22	
10	4	12.6	23	72	97.2	0.45	
13	6.7	16.8	27.5	89	127	1.15	
16	10	21	33.5	103	145	1.75	
20	16	24.5	42	116	175	2.7	
22	19	27	48	135	193	4.02	
26	26.5	32	61	164	228	5.1	
32	39.3	40	80	194	274	8.5	

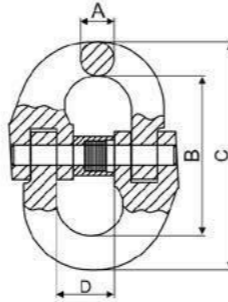

G100 EYE SLING HOOK WITH LATCH



Chain Size	WLL	Main Dimensions (mm)						Weight
		D	E	H	x	L	kg	
mm	ton							
6	1.4	10	18.5	21	20.5	111	0.32	
8	2.5	11	25	27.5	25	137.5	0.6	
10	4	16	28	33	34	171.5	1.2	
13	6.7	19	38	43.5	43	219	2.2	
16	10	24.5	44	50	50	260	3.5	
20	16	27	52	56	55	298	7.15	
22	19	29	66	62	60	330	11.5	
26	26.5	35	73	75	70	367	14	
32	39.3	39	87	89	66	427	17.5	

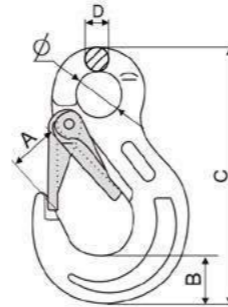

G100 CLEVIS SLING HOOK WITH LATCH



Chain Size	WLL	Main Dimensions (mm)							Weight
		A	B	E	H	M	L	kg	
mm	ton								
6	1.4	7.5	32	18.5	21	68.5	109	0.33	
8	2.5	9.5	37	25	27.5	88	134	0.7	
10	4	12	48	28	33.5	105.5	161.5	1.3	
13	6.7	15	59	38	42	134	203	2.3	
16	10	17.5	70	44	50	160.5	248	3.6	
20	16	25	85	52	56	190.5	297	7.3	
22	19	27	100	66	62	214.5	326	12.1	

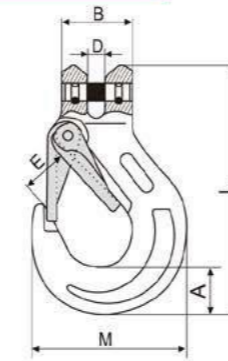

G100 EYE SHORTENING HOOK



Chain Size	WLL	Main Dimensions (mm)				Weight
		E	D	M	kg	
mm	ton					
6	1.4	8	14.5	30.5	43.5	0.2
8	2.5	10.8	18	37	53	0.28
10	4	13.5	22.5	48.5	42	0.72
13	6.7	16.5	28	59	96	1.6
16	10	19.2	36	74	112.5	2.45
20	16	24	43.5	89.5	143	4.72
22	19	27	48.5	100.5	160.5	8.2

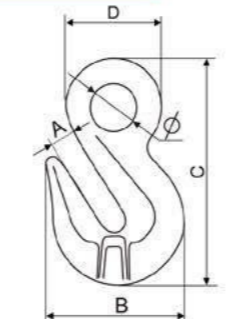

G100 EUROPEAN TYPE EYE SELF LOCKING HOOK



Chain Size	WLL	Main Dimensions (mm)						Weight
		D	E	H	R	M	kg	
mm	ton							
6	1.4	21	43	28	20	110	70	0.5
8	2.5	27	51	35.5	26	137	90	0.9
10	4	34.5	64.5	45	30	169	108	1.5
13	6.7	40	80	53.5	40.5	209	138.5	2.7
16	10	50	104	62	50.5	254	170.5	5.7
20	16	60	120	76.5	62	277	192.5	7.9
22	19	70	134	80	66	319.5	205	11.2

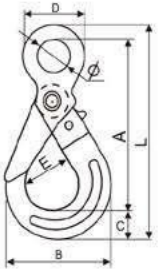

G100 EUROPEAN TYPE CLEVIS SELF LOCKING HOOK



Chain Size	WLL	Main Dimensions (mm)							Weight
		A	B	E	H	R	M	kg	
mm	ton								
6	1.4	7.5	32	28	20	96	70	0.5	
8	2.5	9.5	36	35.5	26	123	90	0.9	
10	4	12	46	45	30	144	109	1.6	
13	6.7	15	59	53.5	40.5	182	138.5	2.9	
16	10	17.5	70	62	50.5	217	170.5	5.8	
20	16	25	85	76.5	62	235	192.5	8.6	
22	19	25.5	98	80	66	276.5	205	12.1	

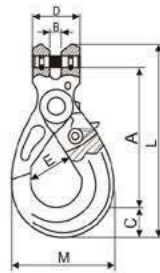

G100 EUROPEAN TYPE SWIVEL SELF LOCKING HOOK



Chain Size	WLL	Main Dimensions (mm)							Weight
		B	C	D	E	H	M	kg	
mm	ton								
6	1.4	32.5	23	11.5	28	20	70	0.6	
8	2.5	36	28	13	35.5	26	90	1.1	
10	4	42	35	15.5	45	30	109	2	
13	6.7	50	40	17	53.5	40.5	138.5	4	
16	10	61	56	21.5	62	50.5	170.5	6.8	
20	16	72	62	26	76.5	62	192.5	12.5	
22	19	97	94	33	80	66	205	17.1	

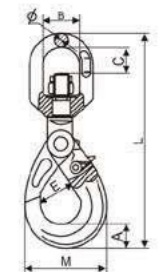

G100 SHORTENING CLEVIS GRAB HOOK



Chain Size	WLL	Main Dimensions (mm)					Weight	
		A	B	E	M	L		kg
mm	ton							
6	1.4	7.5	32	8	43.5	75	0.22	
8	2.5	9.5	36	10.8	53	91.5	0.34	
10	4	12	46	13.5	72	126	0.82	
13	6.7	15	59	16.5	96	163.5	1.75	
16	10	17.5	70	19.2	112.5	183.5	2.88	
20	16	24	85	24	143	224	4.84	
22	19	27	100	27	160.5	262	8.3	

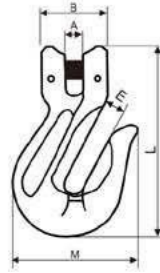

G100 OMEGA LINK



Chain Size	WLL	Main Dimensions (mm)					Weight	
		A	B	E	M	L		kg
mm	ton							
6	1.4	8.5	34	20	44	55	0.12	
8	2.5	10.5	46.5	24	60	73.5	0.27	
10	4	12.5	52	31	70	90	0.44	
13	6.7	16	65	38.5	90	109	0.89	
16	10	19	92.5	51	112	141.5	1.69	

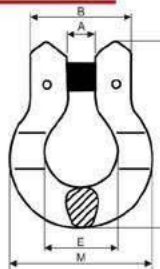

G100 MASTER LINK WITH FLAT



Chain Size(mm)		WLL	Main Dimensions (mm)			Weight
1 leg	2 legs	ton	A	B	D	kg
5	5	1.4	80	50	10	0.14
6+7	6	2.3	110	60	13	0.34
8	7	3.5	110	60	16	0.53
10	8	5	135	75	18	0.86
13	10	7.6	160	90	23	1.60
16	13	10	180	100	27	2.46
19	16	14	200	110	33	4.14
22	19	25.1	260	140	36	6.22
26	22	30.8	340	180	45	12.85
32	26	40	350	190	50	16.22
/	32	60	400	200	60	27.01
/	/	81.5	460	250	70	45.00

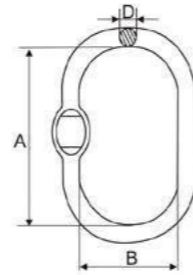

G100 WELDED MASTER LINK ASSEMBLY WITH FLAT



WLL	B.L	Main Dimensions (mm)						Weight
ton	ton	A	B	D	a	b	d	kg
3.5	14	150	90	19	120	70	14	1.8
5	20	160	95	22	140	80	17	3
11.5	46	200	120	30	160	95	22	6.5
17	68	250	150	40	200	120	30	15
28	172	300	200	50	200	120	32	23

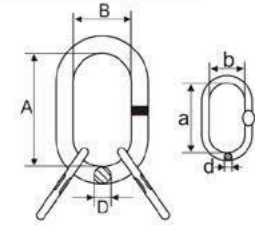

G100 MASTER LINK ASSEMBLY WITH FLAT



Chain Size	WLL	Main Dimensions (mm)						Weight
mm	ton	A	B	D	a	b	d	kg
6	3	135	75	19	54	25	13	1.3
8	5.3	160	90	23	70	35	16.5	2.33
10	8	180	100	27	85	40	19	3.7
13	14	200	110	33	115	50	23	6.5
16	21.2	260	140	36	140	65	27	10.1
20	33.6	350	190	50	150	70	33	22.8
22	39.9	350	190	50	180	100	36	26

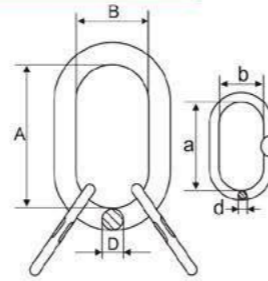

G100 U.S. TYPE MASTER LINK ASSEMBLY



Chain Size	WLL(T)	Main Dimensions (mm)						Weight
inch	3or4leg(0-45°)	A	B	D	a	b	d	kg
1/4	4.2	140	70	20	85	40	14	1.55
5/16	5.3	160	95	22	85	40	14	2.18
3/8	8	178	89	25	100	60	18	3.29
1/2	14	220	110	32	100	60	22	7.18
5/8	21.2							
5/8	21.2	267	135	38	180	100	30	12.91
3/4	30	305	152	45	180	100	32	21.25
7/8	39.4	356	178	50	180	100	38	30.34
1	55.5	406	203	64	355	178	51	64.4
1-1/4	85	406	241	70	406	203	57	89

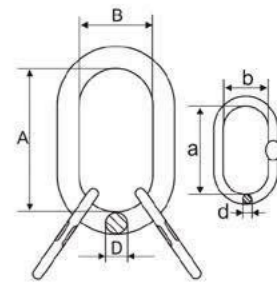

G100 WELDED MASTER LINK WITH FLAT



Chain Size	WLL	B.L	Main Dimensions (mm)			Weight
mm	ton	ton	A	B	D	kg
0806	2.5	10	120	70	14	0.4
1008	4	16	140	80	17	0.7
1310	7.5	30	160	95	22	1.5
1613	10	40	190	110	25	2.2
2016	17	68	240	140	34	5.1
2220	25	100	250	150	38	7.2

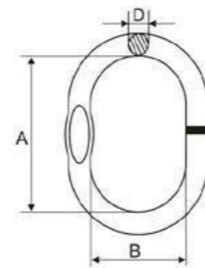

G100 U.S. TYPE MASTER LINK



Chain Size	WLL(T)		Main Dimensions (mm)			Weight
inch	1leg	2legs(0-45°)	A	B	D	kg
1/4	2	2.8	127	63.5	13	0.36
5/16	2.5	/				
5/16	2.5	3.55	152	76	16	0.7
3/8	4	/	140	70	19	0.93
3/8	4	5.6	160	90	22	1.5
1/2	6.7	/				
1/2	6.7	9.5	178	89	25	2.1
5/8	10	/				
5/8	10	14	222	111	32	4.24
3/4	14	/				
3/4	14	20	267	135	38	7.17
7/8	18.8	26.5				
7/8	18.8	26.5	305	152	45	11.55
1	26.5	/				
1	26.5	37	355	178	51	17.2
1-1/4	40	56	406	203	57	24.5
/	/	/	406	203	63.5	30.9
/	/	/	406	241	70	39.5
/	/	/	457	228	76	50.34
/	/	/	508	254	82.5	65.68
/	/	/	610	305	89	90.24
/	/	/	508	254	95	89.27
/	/	/	508	254	102	103.43

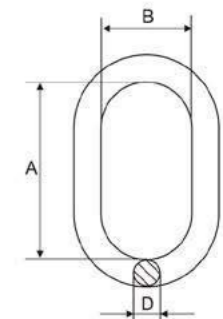

G100 WELDED MASTER LINK WITH FLAT



Chain Size	WLL	B.L	Main Dimensions (mm)			Weight
mm	ton	ton	A	B	D	kg
1008	4	16	340	180	25	3.7
1310	6.5	26	340	180	28	4.7
1613	10	40	340	180	34	7
1916	14.4	57.6	340	180	38	8.9

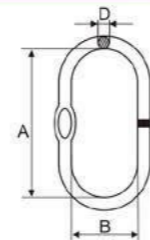

PROOF COIL CHAIN ASTM80 (G30)

Nominal Size		Breaking Load (min)		Weight per 100'		Inside Length(max.)		Inside Width (min)	
inch	mm	kN	lbs	kg	lbs	inch	mm	inch	mm
1/8	4.0	7.56	1,700	8.8	19	0.89	22.6	0.29	7.4
3/16	5.5	14.20	3,200	18.3	40	0.95	24.1	0.40	10.2
1/4	7.1	23.60	5,300	32.7	72	1.00	25.4	0.50	12.7
5/16	8.7	35.60	8,000	48.0	106	1.10	27.9	0.50	12.7
3/8	10.3	49.80	11,200	70.3	155	1.23	31.2	0.62	15.7
1/2	13.5	85.80	19,300	123.0	271	1.53	38.9	0.80	20.3
5/8	16.7	131.60	29,600	184.0	405	1.90	48.3	1.00	25.4
3/4	19.8	185.00	41,600	264.0	582	2.15	54.6	1.12	28.4
7/8	23.0	249.00	56,000	368.0	811	2.50	63.5	1.37	34.8
1	26.5	330.80	74,400	474.0	1,045	2.75	69.9	1.50	38.1

PROOF COIL CHAIN NACM84/90 (G30)

Nominal Size		Breaking Load (min)		Weight per 100'		Inside Length(max.)		Inside Width (min)	
inch	mm	kN	lbs	kg	lbs	inch	mm	inch	mm
1/8	4.0	7.1	1,600	9.0	19.8	0.94	23.9	0.25	6.4
3/16	5.5	14.3	3,200	18.3	40.3	0.98	24.8	0.30	7.7
1/4	7.0	23.1	5,200	30.0	66.1	1.24	31.5	0.38	9.8
5/16	8.0	30.2	6,800	39.0	86.0	1.29	32.8	0.44	11.2
3/8	10.0	47.1	10,600	64.5	142.0	1.38	35.0	0.55	14.0
1/2	13.0	79.6	17,900	110.0	242.0	1.79	45.5	0.72	18.2
5/8	16.0	120.6	27,200	162.0	357.0	2.20	56.0	0.79	20.0
3/4	20.0	188.5	42,400	254.0	560.0	2.76	70.0	0.98	25.0
7/8	22.0	228.1	51,200	306.0	675.0	3.03	77.0	1.03	27.5
1	26.0	318.2	71,600	419.0	924.0	3.58	90.9	1.25	31.7

PROOF COIL CHAIN NACM96 (G30)

Nominal Size		Breaking Load (min)		Inside Length(max.)		Inside Width (min)	
inch	mm	kN	lbs	inch	mm	inch	mm
1/8	4.0	7.2	1,600	0.94	23.9	0.25	6.4
3/16	5.5	14.4	3,200	0.98	24.8	0.30	7.7
1/4	7.0	23.2	5,200	1.24	31.5	0.38	9.8
5/16	8.0	33.8	7,600	1.29	32.8	0.44	11.2
3/8	10.0	47.2	10,600	1.38	35.0	0.55	14.0
7/16	11.9	65.8	14,800	1.64	41.5	0.65	16.6
1/2	13.0	80.0	18,000	1.79	45.5	0.72	18.2
5/8	16.0	122.8	27,600	2.20	56.0	0.79	20.0
3/4	20.0	188.6	42,400	2.78	70.0	0.98	25.0
7/8	22.0	228.2	51,200	3.03	77.0	1.08	27.5
1	26.0	318.2	71,600	3.58	90.9	1.25	31.7

HIGH TEST CHAIN ASTM80(G43)

Nominal Size		Breaking Load (min)		Weight per 100'		Inside Length(max.)		Inside Width (min)	
inch	mm	kN	lbs	kg	lbs	inch	mm	inch	mm
1/4	7.1	34.5	7,750	36.3	80	0.86	21.8	0.4	10.2
5/16	8.7	51.6	11,600	50.4	111	1.05	26.7	0.48	12.2
3/8	10.3	72	16,200	72.6	160	1.19	30.3	0.58	14.7
1/2	13.5	122.7	27,600	128.6	284	1.43	36	0.75	19.1

HIGH TEST CHAIN NACM84/90 (G43)

Nominal Size		Breaking Load (min)		Weight per 100'		Inside Length(max.)		Inside Width (min)	
inch	mm	kN	lbs	kg	lbs	inch	mm	inch	mm
1/4	7.0	33.1	7,500	30	66.1	1.24	31.5	0.38	9.8
5/16	8.0	43.2	9,700	39	86	1.29	32.8	0.44	11.2
3/8	10.0	67.6	15,200	67.3	148	1.38	35	0.55	14
1/2	13.0	114.2	25,700	110	242	1.79	45.5	0.72	18.2

HIGH TEST CHAIN NACM96 (G43)

Nominal Size		Breaking Load (min)		Inside Length(max.)		Inside Width (min)	
inch	mm	kN	lbs	inch	mm	inch	mm
1/4	7.0	34.6	7,800	1.24	31.5	0.38	9.8
5/16	8.7	52	11,700	1.29	32.8	0.44	11.2
3/8	10.0	72	16,200	1.38	35	0.55	14
7/16	11.0	96	21,600	1.64	41.6	0.65	16.6
1/2	13.0	122.6	27,600	1.79	45.5	0.72	18.2
5/8	16.0	173.0	39,000	2.2	56	0.79	20.0

TRANSPORT CHAIN ASTM80 (G70)

Nominal Size		Breaking Load (min)		Weight per 100'		Inside Length(max.)		Inside Width (min)	
inch	mm	kN	lbs	kg	lbs	inch	mm	inch	mm
1/4	7.1	56	12,600	34	75	0.86	21.8	0.45	11.4
5/16	8.7	83.6	18,800	50.4	111	1.01	25.6	0.46	11.7
3/8	10.3	117.4	26,400	71	156	1.19	30.2	0.55	14

TRANSPORT CHAIN NACM84/90 (G70)

Nominal Size		Breaking Load (min)		Weight per 100'		Inside Length(max.)		Inside Width (min)	
inch	mm	kN	lbs	kg	lbs	inch	mm	inch	mm
1/4	7.0	53.9	12,100	30	66.1	1.24	31.5	0.38	9.8
5/16	8.7	83.5	18,800	47	104	1.29	32.8	0.44	11.2
3/8	10.0	110	24,700	64.5	142	1.38	35.0	0.55	14.0

TRANSPORT CHAIN NACM96 (G70)

Nominal Size		Breaking Load (min)		Inside Length(max.)		Inside Width (min)	
inch	mm	kN	lbs	inch	mm	inch	mm
1/4	7.0	56	12,600	1.24	31.5	0.38	9.8
5/16	8.7	83.6	18,800	1.29	32.8	0.44	11.2
3/8	10.0	117.4	26,400	1.38	35.0	0.55	14.0
1/2	13.5	200.8	45,200	1.79	45.5	0.72	18.2

TRAILER SAFETY CHAIN ASSEMBLY WITH S HOOK BOTH END

Trailer Classification	Chain Size	S-hook Size	Min. Breaking lbs
	inch	inch	
1	3/16	3/8	2,000
2	3/16	3/8	3,000
3	1/4	7/16	5,000
4	5/16	17/32	7,000
4	3/8	17/32	7,000



TRAILER SAFETY S-HOOK WITH OR WITHOUT LATCH, ZINC PLATED

S-hook Size	Min. Breaking
inch	lbs
3/8	3,000
7/16	5,000
17/32	7,600



TRAILER SAFETY CHAIN ASSEMBLIES WITH CLEVIS SLIP HOOK WITH LATCH

Chain Size	Min. Breaking	Chain Grade
inch	lbs	
1/4	7,800	G-43 High Test
5/16	10,800	G-43 High Test
3/8	16,200	G-43 High Test
1/4	12,600	G-70 Transport Chain
5/16	18,800	G-70 Transport Chain
3/8	26,400	G-70 Transport Chain



TIE-DOWN CHAIN WITH BELT HOOK

Chain Dia (mm)	Length (feet)	S.W.L. (ton)	Breaking load (ton)	N.W. (kgs)
7.1	9	1.6	6.5	3.3
	12	1.6	6.5	4.2
	15	1.6	6.5	5.1
	18	1.6	6.5	6.3
8	9	2	8	4.2
	12	2	8	5.5
	15	2	8	6.9
	18	2	8	8.5
10	9	3.2	13	6.5
	12	3.2	13	8.5
	15	3.2	13	10.5
	18	3.2	13	13.2
13	9	5.5	22	10.8
	12	5.5	22	14.1
	15	5.5	22	17.4
	18	5.5	22	21.6



CHAIN WITH CLEVIS/EYE GRAB HOOKS BOTH END

Size	ASTM80			NACM90			NACM96			PCS per Drum
	WT. (kg)	W.L.L. (lbs)	MBS (lbs)	WT. (kg)	W.L.L. (lbs)	MBS (lbs)	WT. (kg)	W.L.L. (lbs)	MBS (lbs)	
Grade 43										
1/4" x 14'	5.0	2,600	7,500	4.5	2,600	7,500	4.5	2,600	7,800	50
1/4" x 16'	6.0	2,600	7,500	5.0	2,600	7,500	5.0	2,600	7,800	40
5/16" x 14'	7.5	3,900	11,600	6.0	3,900	9,700	7.0	3,900	11,700	35
5/16" x 16'	8.5	3,900	11,600	6.8	3,900	9,700	8.0	3,900	11,700	30
5/16" x 18'	9.5	3,900	11,600	7.5	3,900	9,700	9.0	3,900	11,700	30
5/16" x 20'	10.5	3,900	11,600	8.0	3,900	9,700	9.5	3,900	11,700	25
5/16" x 25'	13.0	3,900	11,600	10.0	3,900	9,700	12.0	3,900	11,700	20
5/16" x 30'	15.5	3,900	11,600	12.0	3,900	9,700	14.0	3,900	11,700	20
3/8" x 14'	10.5	5,400	16,200	9.5	5,400	15,200	10.0	5,400	16,200	25
3/8" x 16'	12.0	5,400	16,200	11.0	5,400	15,200	11.5	5,400	16,200	25
3/8" x 20'	15.0	5,400	16,200	13.5	5,400	15,200	13.5	5,400	16,200	20
3/8" x 25'	18.5	5,400	16,200	16.5	5,400	15,200	17.5	5,400	16,200	20
Grade 70										
1/4" x 14'	5.0	3,150	12,600	4.5	3,150	12,100	4.0	3,150	12,600	50
1/4" x 16'	6.0	3,150	12,600	5.0	3,150	12,100	5.0	3,150	12,600	40
5/16" x 14'	7.5	4,700	18,800	7.0	4,700	18,800	7.0	4,700	18,800	35
5/16" x 16'	8.5	4,700	18,800	8.0	4,700	18,800	8.0	4,700	18,800	30
5/16" x 18'	9.5	4,700	18,800	9.0	4,700	18,800	9.0	4,700	18,800	30
5/16" x 20'	10.5	4,700	18,800	10.0	4,700	18,800	10.0	4,700	18,800	25
5/16" x 25'	13.0	4,700	18,800	12.0	4,700	18,800	12.0	4,700	18,800	20
5/16" x 30'	15.5	4,700	18,800	14.5	4,700	18,800	14.5	4,700	18,800	20
3/8" x 14'	10.5	6,600	26,400	9.5	6,600	24,700	10.0	6,600	26,400	25
3/8" x 16'	12.0	6,600	26,400	11.0	6,600	24,700	11.5	6,600	26,400	20
3/8" x 20'	15.0	6,600	26,400	13.5	6,600	24,700	14.5	6,600	26,400	20
3/8" x 25'	18.5	6,600	26,400	16.5	6,600	24,700	18.0	6,600	26,400	15



CHAIN ANCHOR WITH DELTA RING AND EYE GRAB HOOK

Delta Ring Size	Enlarged Link Size	Chain Size & Grade	Qty of Chain link	Hook Size & Grade	Breaking Load (lbs)	Length	Packing
2"	3/8"	1/4" G43	14	5/16" G43	10000	18"	50
2"	3/8"	5/16" G43	11	3/8" G43	10000	18"	50
3"	7/16"	5/16" G70	10	5/16" G70	16200	18"	35
3"	7/16"	5/16" G70	10	3/8" G70	16200	18"	35
3"	7/16"	3/8" G43	5	3/8" G43	16200	12"	35
3"	7/16"	3/8" G43	9	3/8" G43	16200	18"	35
4"	7/16"	3/8" G70	9	3/8" G70	20000	18"	35



AUSTRALIAN TRANSPORT CHAIN AS/NZS 4344

Chain size	Inside Length		Inside Width	Lashing Capacity	Min. Breaking
	max. (mm)	min. (mm)			
mm			mm	kg	kN
6	18.9	17.33	7.88	2300	44.1
7	21.3	19.53	8.88	2900	55.9
7.1	24.0	22.00	10.00	3000	58.9
8	24.0	22.00	10.00	3800	73.6
10	30.0	27.50	12.50	6000	118
13	39.0	35.75	16.25	9000	176

GRADE 70 LOAD CHAIN KIT WITH WINGED GRAB HOOK EACH END

Chain size	Chain Length	Lashing Capacity
mm	m	kg
6	9	2300
7.1	9	3000
8	9	3800
10	9	6000



Grade 70 load chain kit with lug link, claw hook and slip hook are available.



CLEVIS GRAB HOOK



Chain Size	W.L.L.(lbs)		Dimensions(inch)				Weight
	Carbon	Alloy	B	E	P	R	
inch							lbs
1/4	2,600	3,600	0.36	0.40	0.38	1.97	0.40
5/16	3,900	5,400	0.40	0.44	0.44	2.26	0.79
3/8	5,400	7,500	0.48	0.50	0.47	2.63	1.00
7/16	7,200	10,000	0.66	0.56	0.56	2.75	1.50
1/2	9,200	12,750	0.75	0.66	0.63	3.19	2.10
5/8	12,750	19,000	0.91	0.78	0.75	4.09	4.20
3/4	18,500	27,000	0.94	0.94	0.88	4.63	6.50

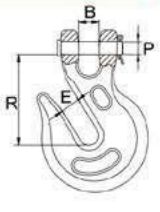

CLEVIS SLIP HOOK



Chain Size	W.L.L.(lbs)		Dimensions(inch)				Weight
	Carbon	Alloy	B	E	P	R	
inch							lbs
1/4	1,950	2,750	0.44	0.94	0.38	2.56	0.50
5/16	2,875	4,300	0.50	1.06	0.44	2.87	0.75
3/8	4,000	5,250	0.59	1.31	0.47	3.25	1.20
7/16	5,000	7,000	0.66	1.56	0.56	3.70	2.06
1/2	6,500	9,000	0.75	1.69	0.63	4.00	2.80
5/8	9,250	12,500	0.91	2.00	0.75	4.94	4.75
3/4	12,500	19,250	1.31	2.50	1.00	6.09	10.30

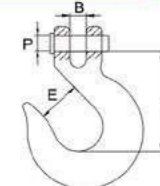

EYE GRAB HOOK



Chain Size	W.L.L.(lbs)		Dimensions(inch)			Weight
	Carbon	Alloy	B	E	R	
inch						lbs
1/4	2,600	3,600	0.50	0.34	1.97	0.28
5/16	3,900	5,400	0.56	0.44	2.25	0.45
3/8	5,400	7,500	0.66	0.50	2.56	0.79
7/16	7,200	10,000	0.75	0.56	2.94	1.19
1/2	9,200	12,750	0.88	0.66	3.38	1.80
5/8	12,750	19,000	1.06	0.78	4.11	3.30
3/4	18,500	27,000	1.38	0.94	5.16	6.00

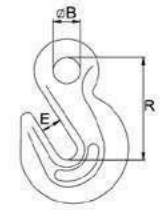

EYE SLIP HOOK



Chain Size	W.L.L.(lbs)		Dimensions(inch)			Weight
	Carbon	Alloy	B	E	R	
inch						lbs
1/4	1,950	2,750	0.50	0.94	2.56	0.40
5/16	2,875	4,300	0.63	1.06	2.95	0.70
3/8	4,000	5,250	0.72	1.31	3.36	1.00
7/16	5,000	7,000	0.81	1.56	3.88	1.60
1/2	6,500	9,000	0.94	1.69	4.28	2.40
5/8	9,250	13,500	1.13	2.00	5.22	4.00
3/4	12,500	19,250	1.38	2.13	5.80	6.50

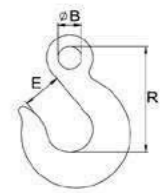

CLEVIS SLIP HOOK WITH LATCH



Chain Size	W.L.L.(lbs)		Dimensions(inch)					Weight
	Carbon	Alloy	B	E	P	R	T	
inch								lbs
1/4	1,950	2,750	0.44	0.79	0.38	2.56	0.79	0.52
5/16	2,875	4,300	0.50	0.93	0.44	2.87	0.79	0.77
3/8	4,000	5,250	0.59	1.14	0.47	3.25	1.02	1.23
7/16	5,000	7,000	0.66	1.18	0.56	3.70	1.06	2.10
1/2	6,500	9,000	0.75	1.42	0.63	4.00	1.38	2.85
5/8	9,250	12,500	0.91	1.65	0.75	4.94	1.69	5.18
3/4	12,500	19,250	1.31	1.81	1.00	6.09	1.81	10.45
1	17,600	26,500	1.38	1.98	1.14	7.40	2.50	13.65

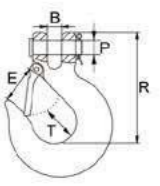

EYE SLIP HOOK WITH LATCH



Chain Size	W.L.L.(lbs)		Dimensions(inch)				Weight
	Carbon	Alloy	B	E	P	T	
inch							lbs
1/4	1,950	2,750	0.50	0.75	2.56	0.79	0.42
5/16	2,875	4,300	0.63	0.88	2.95	0.79	0.72
3/8	4,000	5,250	0.72	1.10	3.36	1.02	1.03
7/16	5,000	7,000	0.81	1.25	3.88	1.06	1.64
1/2	6,500	9,000	0.94	1.38	4.28	1.30	2.45
5/8	9,250	13,500	1.13	1.45	5.22	1.53	4.13
3/4	12,500	19,250	1.38	1.59	5.80	1.62	6.76

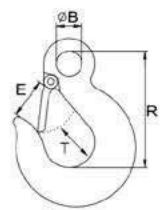

Chain Size

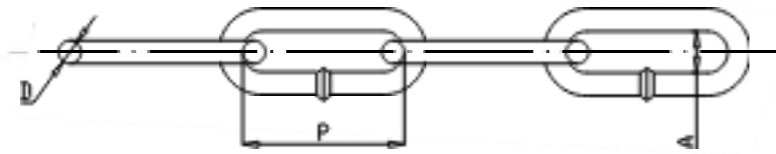

D(mm)	P(mm)	A(mm)	B.L. (t)
5	35	9	3
5	35.75	9	3
5	46	7.5	5
6	35	9	4.5
7	46	9	6
10	65	20	12.6
11	72	19	15

Stainless steel chain is available

Convey Size

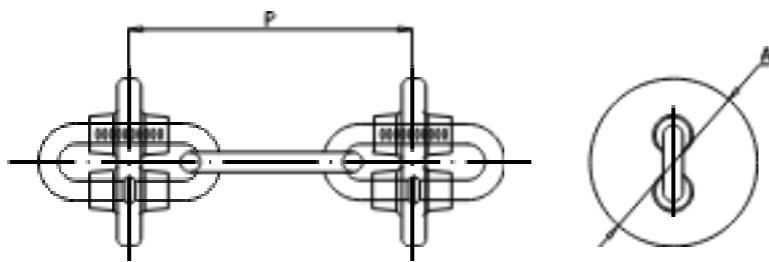

Chain Size (mm)	A(mm)	P(mm)	Min. Pulling force
5 x 35 x 9	35	70	280kg
5 x 35 x 9	42	70	350kg
5 x 35 x 9	43.5	70	350kg
5 x 35.75 x 9	42	71.5	400kg
5 x 46 x 7.5	42	92	250kg
5 x 46 x 7.5	58	92	300kg
6 x 35 x 9	42	70	350kg
6 x 35 x 9	52	70	400kg
7 x 46 x 9	75	92	800kg
10 x 65 x 20	101.6	130	800kg
10 x 65 x 20	127	130	800kg
11 x 72 x 19	130	144	1000kg

Disk Type

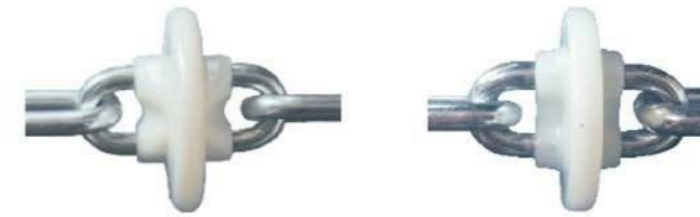

Round Edge

圓型

Flat Edge

方型

Disk Material

- Polyamide (PA6 & PA66)
- UHMWPE

Disk Stabilization

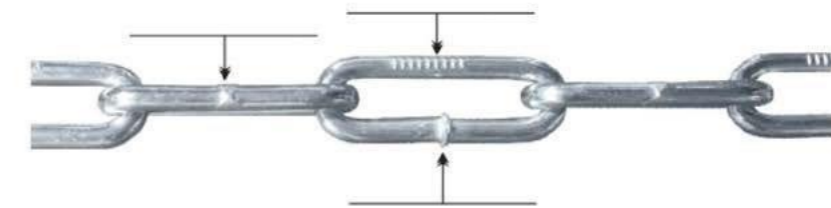

For the link which we inject the disk, we don't clear the welding point and we also stamp the back of the link to create serrated surface. The welding point and stamp help to stabilize the disk. For the link which we don't inject the disk, we clear the welding point to make the chain disk more beautiful and safe to handle.

Our customer



Shackle

SCREW PIN ANCHOR SHACKLE



Size	W.L.L.	Dimensions (mm)						Weight kg
		A	B	C	D	E	L	
3/16"	1/3T	9.65	6.35	22.4	4.85	15.2	37.3	0.03
1/4"	1/2T	11.9	7.85	28.7	6.35	19.8	46.7	0.05
5/16"	3/4T	13.5	9.65	31	7.85	21.3	53	0.09
3/8"	1T	16.8	11.2	36.6	9.65	26.2	63	0.14
7/16"	1-1/2T	19.1	12.7	42.9	11.2	29.5	74	0.17
1/2"	2T	20.6	16	47.8	12.7	33.3	83.5	0.33
5/8"	3-1/4T	26.9	19.1	60.5	16	42.9	106	0.62
3/4"	4-3/4T	31.8	22.4	71.5	19.1	51	126	1.07
7/8"	6-1/2T	36.6	25.4	84	22.4	58	148	1.64
1"	8-1/2T	42.9	28.7	95.5	25.4	68.5	167	2.28
1-1/8"	9-1/2T	46	31.8	108	29.5	74	190	3.36
1-1/4"	12T	51.5	35.1	119	32.8	82.5	210	4.31
1-3/8"	13-1/2T	57	38.1	133	36.1	92	233	6.14
1-1/2"	17T	60.5	41.4	146	39.1	98.5	254	7.8
1-3/4"	25T	73	51	178	46.7	127	313	12.6
2"	35T	82.5	57	197	53	146	348	20.4
1-1/2"	55T	105	70	267	69	184	453	38.9

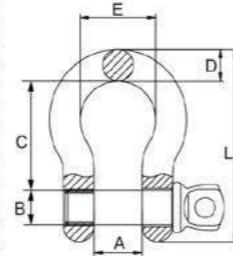

Spec. To RR-C-271D,
Type 4A,
Grade A, Class 2
MIN. B.L. = 6xWLL

Shackle

SCREW PIN CHAIN SHACKLE



Size	W.L.L.	Dimensions (mm)						Weight kg
		A	B	C	D	E	L	
3/16"	1/3T	9.65	6.35	19	4.85	19.35	33.9	0.022
1/4"	1/2T	11.9	7.85	22.4	6.35	24.6	40.4	0.05
5/16"	3/4T	13.5	9.65	26.2	7.85	29.5	48.5	0.08
3/8"	1T	16.8	11.2	31.8	9.65	35.8	58.5	0.13
7/16"	1-1/2T	19.1	12.7	36.6	11.2	41.4	67.5	0.2
1/2"	2T	20.6	16	41.4	12.7	46	77	0.27
5/8"	3-1/4T	26.9	19.1	51	16	58.5	95.5	0.57
3/4"	4-3/4T	31.8	22.4	60.5	19.1	70	115	1.2
7/8"	6-1/2T	36.6	25.4	71.5	22.4	81	135	1.43
1"	8-1/2T	42.9	28.7	81	25.4	93.5	151	2.15
1-1/8"	9-1/2T	46	31.8	91	28.7	103	172	3.06
1-1/4"	12T	51.5	35.1	100	31.8	115	191	4.11
1-3/8"	13-1/2T	57	38.1	111	35.1	127	210	5.28
1-1/2"	17T	60.5	41.4	122	38.1	137	230	7.23
1-3/4"	25T	73	51	146	44.5	162	279	12.1
2"	35T	82.5	57	172	51	184	312	19.2
1-1/2"	55T	105	70	203	66.5	238	377	32.5

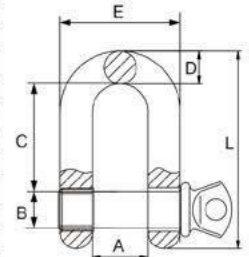

Spec. To RR-C-271D,
Type 4B,
Grade A, Class 2
MIN. B.L. = 6xWLL

BOLT TYPE ANCHOR SHACKLE



Size	W.L.L.	Dimensions (mm)						Weight kg
		A	B	C	D	E	L	
3/16"	1/3T	9.65	6.35	22.4	4.85	15.2	37.3	0.03
1/4"	1/2T	11.9	7.85	28.7	6.35	19.8	46.7	0.05
5/16"	3/4T	13.5	9.65	31	7.85	21.3	53	0.1
3/8"	1T	16.8	11.2	36.6	9.65	26.2	63	0.15
7/16"	1-1/2T	19.1	12.7	42.9	11.2	29.5	74	0.22
1/2"	2T	20.6	16	47.8	12.7	33.3	83.5	0.36
5/8"	3-1/4T	26.9	19.1	60.5	16	42.9	106	0.76
3/4"	4-3/4T	31.8	22.4	71.5	19.1	51	126	1.23
7/8"	6-1/2T	36.6	25.4	84	22.4	58	148	1.79
1"	8-1/2T	42.9	28.7	95.5	25.4	68.5	167	2.57
1-1/8"	9-1/2T	46	31.8	108	28.7	74	190	3.75
1-1/4"	12T	51.5	35.1	119	31.8	82.5	210	5.31
1-3/8"	13-1/2T	57	38.1	133	35.1	92	233	7.18
1-1/2"	17T	60.5	41.4	146	38.1	98.5	254	9.43
1-3/4"	25T	73	51	178	44.5	127	313	15.4
2"	35T	82.5	57	197	51	146	348	23.7
1-1/2"	55T	105	70	267	66.5	184	453	38.9
3"	85T	127	82.5	330	76	200	546	70
3-1/2"	120T	133	95.5	372	92	229	626	120
4"	150T	140	108	368	104	254	653	153

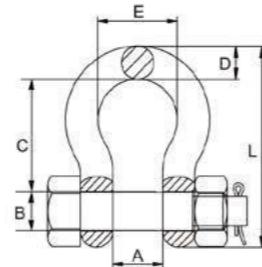

Spec. To RR-C-271D,
Type 4A,
Grade A, Class 3
MIN. B.L. = 6xWLL

BOLT TYPE CHAINSHACKLE



Size	W.L.L.	Dimensions (mm)						Weight kg
		A	B	D	C	L	E	
1/4"	1/2T	11.9	7.85	6.35	19.05	40.4	24.6	0.06
5/16"	3/4T	13.5	9.65	7.85	25.4	48.5	29.5	0.1
3/8"	1T	16.8	11.2	9.65	30.99	58.5	35.8	0.15
7/16"	1-1/2T	19.1	12.7	11.2	36.09	67.5	41.1	0.22
1/2"	2T	20.6	16	12.7	41.04	77	46	0.34
5/8"	3-1/4T	26.9	19.1	16	50.8	95.5	58.5	0.67
3/4"	4-3/4T	31.8	22.4	19.1	60.45	115	70	1.14
7/8"	6-1/2T	36.6	25.4	22.4	71.37	135	81	1.74
1"	8-1/2T	42.9	28.7	25.4	81.03	151	93.5	2.52
1-1/8"	9-1/2T	46	31.8	28.7	90.93	172	103	3.45
1-1/4"	12T	51.5	35.1	31.8	100.08	191	115	4.9
1-3/8"	13-1/2T	57	38.1	35.1	111.25	210	127	6.24
1-1/2"	17T	60.5	41.4	38.1	122.17	230	137	8.39
1-3/4"	25T	73	51	44.5	146.05	279	162	14.2
2"	35T	82.5	57	51	171.45	312	184	21.2
1-1/2"	55T	105	70	66.5	203.2	377	238	38.6
3"	85T	127	82.5	76	215.9	429	279	56

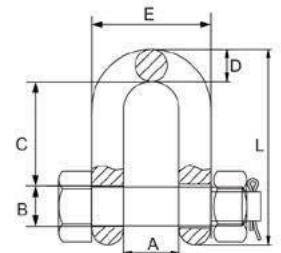

Spec. To RR-C-271D,
Type 4B,
Grade A, Class 3
MIN. B.L. = 6xWLL

EUROPEAN TYPE LARGE BOW SHACKLE



Size	W.L.L.	Dimensions (mm)					Weight kg
		A	B	C	D	E	
5MM	0.08T	10	19	16	5	11	0.017
6MM	0.1T	13	25	20	6	14	0.025
8MM	0.2T	16	32	24	8	18	0.05
10MM	0.32T	19	38	32	10	20	0.09
12MM	0.52T	25	51	38	12	26	0.18
14MM	0.6T	26.5	52	42	14	29	0.28
16MM	0.8T	32	64	46	16	33	0.41
18MM	0.92T	35	70	50	18	36	0.62
20MM	1.1T	38	76	66	20	40	0.8
22MM	1.5T	44	89	74	22	50	1.1
25MM	2.1T	51	100	80	25	57	1.65
28MM	3T	57	115	94	28	68	2.4
32MM	3.5T	64	127	104	32	73	3.5
36MM	4T	72	135	108	36	79	5.1
38MM	5T	76	152	126	38	85	6.35
42MM	6T	80	175	140	42	90	8.4
45MM	7T	90	180	150	45	96	11.5
50MM	8T	102	200	156	50	108	14

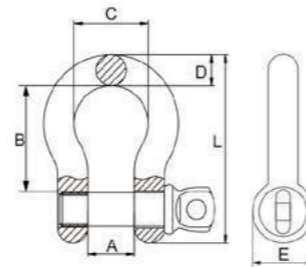

* Galvanized or hot dip galv.

EUROPEAN TYPE LARGE DEE SHACKLE



Size	W.L.L.	Dimensions (mm)				Weight kg
		A	B	C	D	
5MM	0.08T	10	11	19	5	0.015
6MM	0.1T	13	14	25	6	0.024
8MM	0.2T	16	18	32	8	0.05
10MM	0.32T	19	20	38	10	0.085
12MM	0.52T	25	26	51	12	0.17
14MM	0.6T	26.5	28	52	14	0.25
16MM	0.8T	32	33	64	16	0.38
18MM	0.92T	35	35	70	18	0.59
20MM	1.1T	38	40	76	20	0.76
22MM	1.5T	44	50	89	22	1.05
25MM	2.1T	51	57	100	25	1.55
28MM	3T	57	68	115	28	2.25
32MM	3.5T	64	73	127	32	3.35
36MM	4T	72	81	135	36	4.6
38MM	5T	76	85	152	38	5.86
42MM	6T	80	91	175	42	7.9
45MM	7T	90	96	180	45	10
50MM	8T	102	108	200	50	12.5

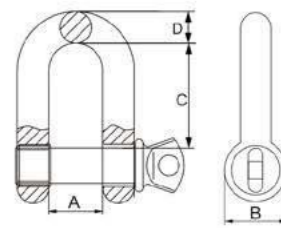

* Galvanized or hot dip galv.

Loadbinder

Loadbinder

RATCHET TYPE LOAD BINDER

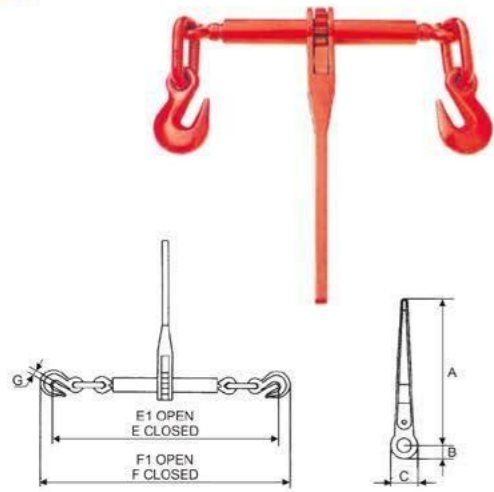

Min.-Max. Chain Size	Inch	1/4-5/16	5/16-3/8	3/8-1/2	1/2-5/8
Working Load Limit	lbs	2600	5400	9200	13000
Proof load	lbs	5200	10800	18400	26000
Minimum Uftimate Load	lbs	92000	19000	33000	46000
Weingt/Each	lbs	3.52	10.5	12.9	14.38
Handle Length	Inch	7.16	13.42	13.92	13.92
Dimensions(Inch)	A	7.16	13.92	13.92	13.92
	B	0.89	1.3	1.3	1.3
	C	1.77	2.6	2.6	2.6
	E	16.22	22.64	24.13	26.45
	E1	21.26	30.64	21.13	34.45
	F	17.79	25.24	27.04	30.07
	F1	22.83	33.24	35.04	38.07
G	0.35	0.51	0.59	0.74	

LEVER TYPE LOAD BINDER

Min.-Max. Chain Size	Inch	1/4-5/16	5-16-3/8	3/8-1/2	1/2-5/8
Working Load Limit	lbs	2600	5400	9200	11000
Proof load	lbs	5200	10800	18400	22000
Minimum Uftimate Load	lbs	7800	19000	28000	44000
Weingt/Each	lbs	3.52	8.37	12.11	19.7
Handle Length	Inch	11.42	15.43	17.24	21
Dimensions(Inch)	A	18.5	25.2	28.5	33.86
	B	17.3	23.2	26.38	30.12
	C	14.17	19.49	22.05	25.78
	D	11.42	15.55	17.64	20.87
	E	8.27	11.22	12.99	14.37
	F	8.07	11.22	12.2	14.37
	G	0.35	0.51	0.59	0.74

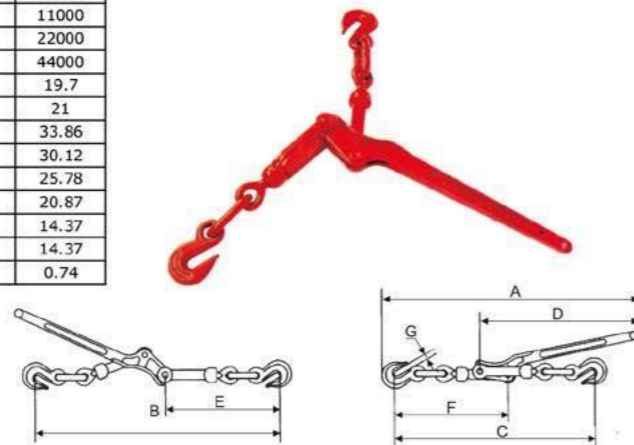

RATCHET TYPE LOAD BINDER WITHOUT LINKS OR HOOKS

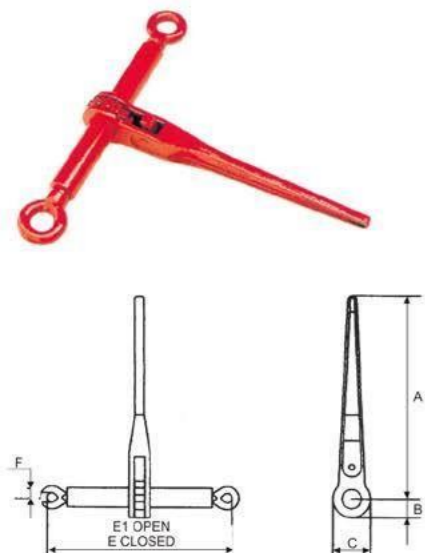

Min.-Max. Chain Size	Inch	5/16-3/8	3/8-1/2	1/2-5/8
Working Load Limit	lbs	5400	9200	13000
Proof load	lbs	10800	18400	26000
Minimum Uftimate Load	lbs	19000	33000	46000
Weingt/Each	lbs	7.8	7.8	8.5
Handle Length	Inch	13.42	13.92	13.92
Dimensions(Inch)	A	13.92	13.92	13.92
	B	1.3	1.3	1.3
	C	2.6	2.6	2.6
	E	13.7	13.7	14.17
	E1	21.7	21.7	22.17
	F	0.79	1.02	1.02

RATCHET TYPE LOAD BINER WITH WINGED GRAB HOOK AND SAFETY PIN

Hooks c/w safety latches.
Easy functioning.
In combination with Grade 80 chain .



Chain Size	WLL	MBL
mm	daN	daN
8	4,000	8,000
10	6,300	12,600
13	10,000	20,000
16	16,000	32,000

LASHING CHAIN WITH RATCHET

Lashing chains are particularly suitable for safe transport of heavy loads such as on low loadbinders or to diagonally tie down containers
All load-bearing parts are forged.
The ratchet features rust-resistant springs for a long service life.

Chain Size	WLL	MBL
mm	daN	daN
8	4,000	8,000
10	6,300	12,600
13	10,000	20,000
16	16,000	32,000

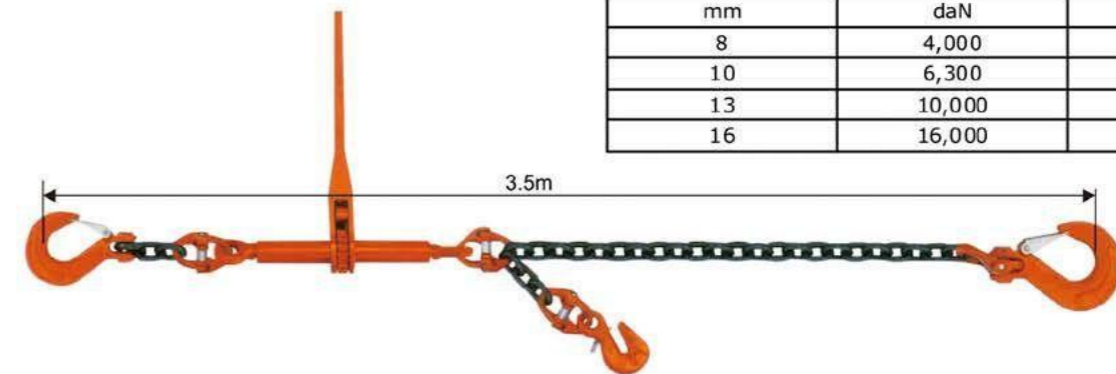

LASHING LEVER

Alloy Steel Forged

Size	Min. Breaking Strength
mm	kg
9	10,000
11	15,000
13	20,000



CHAIN LASHING

Alloy Steel Forged

Size	Min. Breaking Strength
mm	kg
9	10,000
11	15,000
13	20,000





PL CAR CHAINS

PLE CAR CHAINS

PL, PLE CAR CHAINS

PL & PLE series are specially designed for passenger cars.

PL & PLE series passenger car chains excel in their outstanding traction, especially for PLE series snow chains.

They adopt "D" design 4.5mm square link, gaining better traction.

They can be for use on original equipment with highway type tread.



PACKAGE: 1 PAIR PER CASE

TIRE SIZE OF PL PLE CAR CHAINS

Item No.	Tire Size		
PL1110	145R12		
	155R12		
	135R13		
PLE1110	P165/70R12		
	P145/80R12		
	P155/65R13		
	P145/70R13		
	P135/80R13		
PL1114	6.00-12; 145R12; 155R12 P175/70R12; P155/80R12 P165/60R13; P165/65R13	135R14 145R14 P165/60R14 P155/65R14 P145/70R14	135R15
PLE1114	P175/60R13; P185/65R13 P155/70R13; P165/70R13 P165/75R13; P145/80R13 145R13; 155R13; P155/80R13		
PL1118	165R13 P185/60R13; P165/70R13 P175/70R13; P175/75R13	155R14 P175/60R14; P185/60R14 P165/65R14; P185/55R14	P165/65R15 P145/70R15 P155/70R15
PLE1118	P165/80R13	P175/65R14; P155/70R14 P165/70R14; P165/75R14 P165/80R14	P145/80R15 P165/70R360 145R15; P165/70R365
PL1122	P175/80R13	175R14 P195/55R14 P175/75R14 P185/75R14 P175/80R14	5.6-15; 155R15; 165R15 185/55R15; P195/55R15 P185/60R15; P195/60R15 P185/65R15; P165/70R15 P175/70R15; P175/75R15 P165/80R15; P155/80R15
PL1126	175R13; 185R13 P195/60R13; P205/60R13 P215/60R13; P195/65R13	P205/55R14 P195/60R14 P195/65R14	P220/45R15; P195/50R15 P205/50R15; P185/60R15 P185/65R15; P175/70R15
PLE1126	P215/60R13; P195/65R13 P185/70R13; P195/70R13 P185/75R13; P195/75R13 P175/80R13; P185/80R13	P175/70R14 P185/70R14 P185/65R365	P185/65R390
PL1130	195R13 P215/65R13 P205/70R13 P185/85R13	7.00-14LT; 185R14; 6.00-14LT P215/60R14; P225/60R14 P205/65R14; P215/65R14; P195/70R14; P195/75R14 P185/80R14	175R15; P225/50R15P P190/65R15; P195/65R190 P195/65R15; P205/65R15 P185/70R15; P185/70R365 P195/70R15; P185/75R15 P205/60R15; P200/60R390
PL1134	P235/50R13 P245/50R13 P235/60R13	195R14; 205R14 P225/65R14; P235/60R14 P205/70R14; P215/70R14 P205/75R14; P215/75R14	185R15; 195R15 P215/60R15; P225/60R15 P205/65R15; P205/70R15 P195/75R15; P205/75R15 P195/80R15; P205/50R16 P205/55R16; P215/55R16 P205/60ZR16; P215/60ZR16
PL1138		205R14; 215R14 P265/50R14; P255/55R14 P245/60R14; P255/60R14 P225/70R14; P235/70R14 P225/75R14	7.75-15; 205R15; 215R15 P245/50R15; P215/60R15 P235/60R15; P165/65R15 P225/65R15; P215/70R15 P225/70R15; P205/75R15 P225/55R16; P205/75R15 P215/75R15; P245/50ZR16 P235/45R17; P220/65R390 P225/60ZR16; P205/65R16 P215/60ZR16
PL1142		225R14 P265/60R14 P275/60R14 P245/70R14	8.55-15; 215R15 225R15; 230R15; 235R15 P265/50R15; P275/50R15 245/60R15; P255/60R15 P265/60R15; P275/60R15 P255/65R15; P235/70R15 P245/70R15; P225/75R15 P235/75R15; P225/80R15 P235/60R16; P245/60R16



18 (V-BAR REINFORCED)

12 (REGULAR)

12, 18 CAR CHAINS

- 12, 18 series passenger car chains are designed for vehicles requiring SAE class "U" tire chains.
- Vehicles with regular non-restricted wheel well clearances.
- Do not use these chains on vehicles designated as SAE class "S" limited clearance.
- V car design makes it especially good for ice road drive.(18 car chains only.)



TIRE SIZE OF 12, 18 CAR CHAINS

Item No.	Tire Size		
1206	6.00-12; 165/70-12	135-14; 165/65-14	135-15
1806	145-12; 155-12 175/70-12; 155/80-12 145-13; 155-13 145/80-12; 175/60-13 165/70-13; 135-13 165/65-13; 145/80-13 155/70-13		
1210	215/50-13; 165-13 185/60-13; 175/70-13 175-13	6.00-14; 175/65-14; 175-14	5.60-15; 165-15; 175/70-15
1217	155/80-13; 165/75-13	195/55-14; 155-14	155-15; 185/55-15; 145-15
1817	185-13	175/60-14; 165/70-14 165/75-14; 165/80-14 175/75-14; 165-14 175/70-14	165/65-15; 155/80-15
1230	195/60-13; 165/80-13 205/60-13; 175/80-13 235/50-13; 245/50-13 185/70-13; 195/70-13 185/75-13; 185/80-13	185/65-14; 205/60-14 195/60-14; 195/65-14 205/55-14; 185/70-14 185/60-14; 185-14 225/55-14	220/45-15; 195/50-15 205/50-15; 185/60-15 185/65-15; 195/55-15 215/50-15; 185/75-15 175-15; 225/50-15 195/60-15; 195/65-15 205/55-15; 205/55ZR16 205/75-15
1240		7.00-14; 215/60-14	185/70-15; 185-15; 195-15
1840		205/65-14; 185/75-14 205/75-14; 185/80-14 195/75-14; 215/65-14 195-14; 205/70-14	205/60-15; 215/60-15 195/70-15; 195/75-15 225/50-16
1250		235/60-14; 235/70-14 225/75-14; 225-14	205/70-15; 215-15 215/70-15; 225/70-15 215/75-15; 225/15; 230-15 235/70-15; 8.55-15 7.00-15
1850			
1254		205-14; 215-14; 225/70-14	7.75-15; 205-15
1854		215/70-14; 225/65-14 215/75-14; 225/60-14	205/65-15; 215/65-15 215/60-16; 225/55-16 225/60-16; 205/65-16 215/65-16; 215/70-16



42 DUAL TRUCK CHAIN



22 SINGLE TRUCK CHAIN

22, 42 TRUCK CHAINS

- 22, 42 series single / dual truck chains are designed specially for truck, with their compact design, they stand out in their strong traction character.
- As to these with "CAM" accessories, tightening becomes much easier.



TIRE SIZE OF 22, 42 TRUCK CHAINS

Item No.	Tire Size
2006/ 4206	8-14.5MH; 6.00-16LT
2209/ 4209	7.00-14LT; 185-14; P195/75R14; P2050/75R14; 195/75R14LT; 205/60R14.5; E78-14ST 28*8.5*14
2211/ 4211	6.7-15LT; 7.00-15LT; 7-17.5LT; P215/75R15; 27*8.5-14LT; H70-14ST; H78-15ST; LR78-15
2214/ 4214	7.5-17; 7.00-18; 8-19.5; 225/75R17.5
2216/ 4216	9-14.5MH; 6.5-16LY; 8.00-16.5; 215/75R14LT; 215/75R15LT; P225/75R15; P235/75R15 205R16; H78-15LT
2219/ 4219	7.00-15TR; 7.50-15LT; 7.00-16LT; 8.75-16.5; 8.50-17.5; 235/75R15LTt; 245/70R15LT; 215/80R16; 215/85R16LT; 225/75R16LT; 235/75R16LT; 215/70R17.5LT; 245/70R16LT; 245/75R15LT
2221/ 4221	7.50-15TR; 7.50-16LT; 9.50-16.5; 7.00-17LT; P265/75R15; 275/60R15LT; 235/85R16LT 245/75R16LT; 215/75R17.5LT; L78-16LT; NR78-15
2228/ 4228	8.25-15TR; 255/85R16LT; 265/75R16
2229/ 4229	10-16.5LT; P245/70R15; P255/70R15LT; 30*9.5-15LT; 30/90.5-16; 32-9-16; 32*10*16 235/70R16LT
2231/ 4231	8.25-15TR; 255/85R16LT; 265/75R16
2233/ 4233	7.50-18; 6.5-20; 7.00-20; 225/70R19.5; 245/70R19.5
2237/ 4237	9.00-15TR; 9.00-16LT; 9R17.5; 10R17.5; 10R17.5; 7.50-20; 8-22.5
2239/ 4239	10.00-15TR; 8.25-20; 9-22.5; 11R17.5; 245/75R22.5; 255/70R22.5; 255/80R22.5; QR78-16
2241/ 4241	9.00-20; 10-22.5; 265/70R19.5; 265/75R22.5
2245/ 4245	10.00-20; 11-22.5; 275/70R22.5; 275/80R22.5
2247/ 4247	295/75R22.5; 275/80R24.5; 285/75R24.5
2249/ 4249	10.00-22; 11-24.5
2251/ 4251	11.00-15TR; 11.00-20; 12-22.5; 295/80R22.5
2253/ 4253	11.00-24
2255/ 4255	12.00-20; 13/80R20; 11.00-22; 12.5-22.5; 12.75-22.5; 12-245; 315/80R22.5
2257/ 4257	13.00-20; 14/80R20; 12.00-24; 365/80R20



48 DUAL TRUCK CHAINS



28 SINGLE TRUCK CHAINS

28, 48 "V" TRUCK CHAINS

- 28, 48 single / dual truck chain is designed specially for truck or bus.
- With its "V" bar across the cross chain, it achieves better traction, especially when drive on ice road.



V-BAR REINFORCED



TIRE SIZE OF 28, 48 "V" BAR TRUCK CHAINS

Item No.	Tire Size
2806/ 4806	8-14.5MH; 6.00-16LT
2809/ 4809	7.00-14LT; 185-14; P195/75R14; P205/75R14; 195/75R14LT; 205/60R17.5; E78-14ST 28*8.50*14
2811/ 4811	6.70-15LT; 7.00-15LT; 7-17.5LT; P215/75R15; 27/8.50-14LT; H70-14ST; H78-14ST H78-15ST; LR78-15
2814/ 4814	7.50-17; 7.00-18; 8-19.5; 225/70R17.5
2816/ 4816	9-14.5MH; 6.50-16LT; 8.00-16.5; 215/75R14LT; P225/75R15; P235/75R15; 205R16 H78-15LT
2819/ 4819	7.00-15TR; 7.50-15LT; 7.00-16LT; 8.75-26.5; 8.50-17.5; 235/75R15LT; 245/70R15LT 215/80R16; 215/85R16LT; 225/75R16LT; 235/75R16LT; 215/70R17.5LT; 245/70R16LT 245/75R15LT
2821/ 4821	7.50-15TR; 7.5-16LT; 9.50-16.5; 7.00-17LT; P265/75R15; 275/60R15LT; 235/85R16LT 24/75R16LT; 215/75R17.5LT; L78-16LT; NR78-15
2828/ 4828	8.25-15TR; 255/85R16LT; 265/75R16
2829/ 4829	10-16.5LT; P245/70R15; P255/70R15LT; 30*9.50-15LT; 30/9.50-16; 32*9*16; 32*10*16 235/70R16LT
2831/ 4831	8.25-15TR; 255/85R16LT; 265/75R16
2833/ 4833	8.50-18; 6.5-20; 7.00-20; 225/70R19.5; 245/70R19.5
2837/ 4837	9.00-15TR; 9.00-16LT; 9R17.5; 10R17.5; 7.50-20; 8-22.5
2839/ 4839	10.00-15TR; 8.25-20; 9-22.5; 11R17.5; 245/75R22.5; 255/70R22.5; 255/80R22.5; QR78-16
2841/ 4841	9.00-20; 10-22.5; 265/70R19.5; 265/75R22.5
2845/ 4845	10.00-20; 11-22.5; 275/70R22.5; 275/80R22.5
2847/ 4847	295/75R22.5; 275/80R24.5; 285/75R24.5
2849/ 4849	10.00-22; 11-24.5
2851/ 4851	11.00-15TR; 11.00-20; 12-22.5; 295/80R22.5
2853/ 4853	10.00-24
2855/ 4855	12.00-20; 13/80R20; 11.00-22; 12.5-22.5; 12.75-22.5; 12-24.5; 315/80R22.5
2857/ 4857	13.00-20; 14/80R20; 12.00-24; 365/80R20



32 TRUCK CHAINS

- Specially designed for dual & wide base truck & bus.
- They can be divided into single / dual two kinds.



TIRE SIZE OF 32 WIDE BASE TRUCK CHAINS

Item No.	Tire size	
3210	10-15LT; 10-16.5LT; 30-9.50-15LT; 29*9.50-16	
3227	11-15LT; 10-17.5LT; 31*10.5R-15LT; 31*11.5-15LT 31*10.5-16.5LT; 31*11.5-16.5LT; 32*9.50-15LT 32*11.5-15LT; 33*9.50R15; 34*9.50-15LT; 11-50-15	
3228	275/70R16	
3229	12-15LT; 12-16.5LT; 31*12.5-15LT; 32*11.5-15LT 32*11.5-15LT; 33*12.5-15LT; 33*12.5-16.5LT 32*12.5-16.5LT; 255/85R16; 245/70R19.5	
3235	14-17.5LT; 35*12.5*15; 35*14*15LT; 36*12.5*15LT 37*12.5*15LT; 38*15*15LT; 36.5*14*16 35*12.5*16.5; 35*14*16.5; 36*14*16.5; 38.5*16*16.5 38*15.5R16.5	
3237	31*15.5-15LT; 35*15*15; 35*15.5*15	7.00-15T; R6.5-16LT; 7-17.5LT
3249	35*14.5*15LT; 38*15.5*15; 38.5*16*15; 38.5*16*16.5	8-17.5LT
3251	35*15-15LT; 36*14*15LT; 36*14.5*15LT; 39.5*15*16.5 40*17*15	7.5-15LT; 7.5-15TR; 7.5-16LT 7.00-17; 235/85R16
3255	16.5-19.5; 15-22.5; 385/65R22.5; 365/80R20 365/70R22.5	
3257	18-19.5	
3259	38*12.5-15LT; 38*14.5*15LT	7.00-18; 8-19.5; 6.50-20; 7-22.5
3261	19.5-19.5; 18-22.5; 445/65R22.5	
3265	38*15*16LT; 15-19.5	7.5-17; 7.00-20
3267	42*15-15LT	7.50-20; 8-22.5
3269	44*18.5*15; 44*18.5*16.5	8.25-20; 9-22.5
3271	16.5-22.5; 425/65R22.5	
3273		9.00-20; 10-22.5
3275		10.00-20; 11-22.5
3277		11.00-20; 10.00-22; 9.00-24 11.00-24.5

Item No.	Tire Size
3210CAM	10-15LT; 10-16.5LT; M-50-15
3227CAM	11-15LT; 10-17.5LT; 31*10.50-15LT; 31*11.50-15LT; 32*11.50-15LT; 31*10.50-16.5LT 31*11.50-16.5LT; 31*15.5-15LT; 32*9.50-15LT
3229CAM	12-15LT; 12-16.5LT; 14.35-15; 12-16.5; 31*12.50-15LT; 33*12.5-15LT; 33*12.5-16.5LT 32*12.50-15LT
3255CAM	16.5-19.5; 15-22.5; 385/65R22.5; 365/80R20; 365/70R22.5

Graden Chains



Item No.	Tire Sizes
3301 --	10/0.5X2.75 10.25X3.25 10X3.50
3308 --	12X3
7106 --	4.10/3.50X4 3.40/3.00X5
3302 --	4.10/3.50X5 4.10/3.50X6 12/3.50X6 12.25/3.50X6
3309 --	5.30/4.50X6
7129 --	13X5X6
1301 --	4.00/4.80X8
3303 --	5.00/5.70X8
3300 --	16X6.50X8 15X6.00X6
3312 --	18X6.50X8
3307 3311	18X8.50X8
3305 3306	18X9.50X8
7145 5320	20X10X8
1308 5318	20X8.00X10 20X8X8
7121 7109	20X10X10
5313 5312	6X12 23X7.50X12
4300 4301	8X12 23X8.50X12
5308 5306	12X12 26X12X12 27X12X12
5307 5303	23X9.50X12 23X10.50X12
1307 1309	8X15 25X8.5X14 27X8.50X15
5305 5304	27X9.50X15
5323 5316	29X12X15
5324 9100	31X15.5X15 33X12.5X15
1311 1310	8X16

GARDEN CHAINS

• Designed for blower & garden tractors, or all terrain vehicles.



2Link Spacing	Tire Sizes
Stock Number	
1302G	4.00X4.80-8
3310G	4.10X3.50-6
7156G	13X5-6
3315G	16X6.50X8

Truck Chains

Light Trucks

6mm -1/4" crossers with round studs

Aggressive, tall round studs grip ice and muddy terrain

Light weight-easy to install

Case hardened alloy



6mm x 12 links	6mm x 14 links	6mm x 16 links	6mm x 14 links	6mm x 14 links
14 crosser	14 crosser	16 crosser	15 crosser	16 crosser
225/75-15	235/85-16	285/75-16	255/85-16	265/75-16
235/70-15	235/80-16	295/75-16	235/85-17	265/65-18
205/80-16	255/70-16	255/80-17	255/80-17	265/70-16
215/75-16	245/75-16	295/70-17	255/70-18	275/70-16
225/75-16	235/65-17	285/75-17	245/70-19.5	265/65-17
215/65-17	245/60-17	295/65-18	255/75-17	255/70-17
215/70-17	275/60-17	275/70-18	245/75-18	275/65-17
225/65-17	225/75-17	285/60-20		275/60-18
	265/60-17	275/60-20		255/65-18
	245/60-18	33*11.5-20		255/55-20
	255/60-18	285/55-20		245/60-20
	235/65-18	275/65-20		255/60-20
	235/55-20			275/55-20
	255/50-20			
	265/45-20			

Light Trucks

- Square studs 7mm (9/32") x 9mm(3/8") provide extreme grip and traction
- Square studs are 35% bigger than round, longer lashing
- "Multi-fit" easily shortened without tools, "Magic links"
- Cams cinch chains snug to the tires
- Deep case hardened, alloy steel



7mm x 8 links	7mm x 9 links	7mm x 9 links	7mm x 11 links	7mm x 11 links	7mm x 11 links	7mm x 13 links	7mm x 13 links
8 crosser	10 crosser	11 crosser	9 crosser	10 crosser	12 crosser	10 crosser	11 crosser
195/75-16	8.25-15	8.25-16	255/70-15	255/85-15	9.00-16	10.00-15	35*12.5-15
195-16	215/80-15	9.5-16	265/70-15	32*11.5-15	8.25-18	33*12.5-15	36*12.5-15
215/75-16	235/75-15	9R-17.5	30*9.5-15	245/85-16	10-19.5	300/70-15	35*12.5-16
225/65-16	7.00-16	9.5-17.5	31*10.5-15	255/85-16	285/70-19.5	12-16.5	255/100-16
8.00-16.5	7.50-16	10-17.5	31*11.5-15	265/75-16	8.25-20	33*12.5-16.5	315/75-16
215/60-17	215/85-16	7.00-18	225/75-16	280/85-16	35*12.5-20	275/60-22.5	36*12.5-16.5
225/55-17	225/85-16	7.50-18	245-16	8.25-17	9-22.5		315/80-16.5
205/65-17.5	235/70-16	225/70-18	245/75-16	265/70-17	9R-22.5		35*12.5-17
205/75-17.5	235/85-16	8-19.5	245/85-16	245/75-17.5	255/70-22.5		315/70-17
	8.75-16.5	255/60-19.5	265/75-16	265/70-17.5	255/80-22.5		9.00-18
	7.00-17	7.00-20	275/70-16	285/75-17.5	265/70-22.5		275/80-19.5
	7.50-17	7.50-20	31*10.5-16	265/70-18	275/80-22.5		295/70-19.5
	235/80-17	8-22.5	9.5-16.5	275/70-18	285/75-22.5		295/75-19.5
	265/65-17		10-16.5	285/65-18	305/70-18		305/70-19.5
	8.5-17.5		265/70-17	285/70-18			295/60-22.5
	205/75-17.5		275/60-17	9-19.5			305/60-22.5
	215/70-17.5		225/70-17.5	245/70-19.5			
	215/75-17.5		265/65-18	265/70-19.5			
	225/75-17.5		245/60-18	275/70-19.5			
	235/75-17.5			235/80-20			
	245/70-17.5			275/60-20			
	235/70-19.5			285/65-20			

Heavy Trucks

- Strong & Light weight
- 7mm(9/32") crossers, deep case hardened
- 6mm(1/4") side chains, hardened alloy
- Crossers per tire equal to Classic 8
- 6 link crosser spacing



Tire Size	Cross link
9.00-20 10-22.5	10
11R-22.5 275/80-22.5 285/75-22.5 295/75-24.5	11
11R-24.5 295/75-24.5	11
12R-22.5 11.0-20 305/75-24.5 315/75-22.5	12
12.0-20 11.0-22 13-22.5	12
12R-24.5 12.0-24	12
315/80-22.5	12
385/65-22.5	16
425/65-22.5	18
445/65-22.5	18
445/50-22.5	17
455/55-22.5	17

Heavy Trucks

"Double duty"

50% more crossers, more traction

4 link crosser spacing



Tire Size	Cross link
11R-22.5	11
11R-24.5	11
12R-22.5	12
12.0-20	12
12R-24.5 12.0-24	12
315/80-22.5	12
385/65-22.5	16
425/65-22.5	18
445/65-22.5	18
445/50-22.5	17
455/55-22.5	17

Heavy Trucks

"Triple duty"

Full crossers, extreme traction

2link crosser spacing



Tire Size	Cross link
11R-22.5	11
11R-24.5	11
12R-22.5 11.0-20	12
12.0-20	12
12R-24.5 12.0-24	12
315/80-22.5	12
385/65-22.5	16
425/65-22.5	18
445/65-22.5	18

Heavy Trucks



Durable & Dependable

8mm (5/16") crossers with oversize round studs

8mm(5/16") side chain, 10mm(3/8") hooks

Deep case hardened alloy

4link crosser spacing

Tire Size	Cross link
9.00-20 10-22.5	9
11R-22.5 275/80-22.5 285/75-22.5 285/80-22.5	10
11R-24.5 295/75-24.5	10
12R-22.5 11.0-20 305/75-24.5 315/75-22.5	11
12.0-20 12R-24.5 11.0-22	11
12.0-24	12
315/80-22.5	12
385/65-22.5	12
425/65-22.5	16
445/65-22.5	16
445/50-22.5	16
455/55-22.5	17

Heavy Trucks



- Double duty
- Increased traction
- Smoother running on steering wheel
- 8mm (5/16") crossers
- 2link crosser spacing

Tire Size
11R-22.5
11R-24.5
12R-22.5
12R-24.5
12.0-24
315/80-22.5
385/65-22.5
425/65-22.5
445/65-22.5
445/50-22.5
455/55-22.5

Heavy Trucks

- Increased side hill grip
- improved control on steering wheels
- 8mm(5/16") crossers

Tire Size
11R-22.5
11R-24.5
12R-22.5
12R-24.5
12.0-24
315/80-22.5
385/65-22.5
425/65-22.5
445/65-22.5



Heavy Trucks

- Same as classic 8, but with square studs
- 35% larger studs increase service life



Tire Size	Cross link
11.00-24.5 295/75-24.5	10
11.00-20 12R-22.5 295/80-22.5	11
11.00-22 12.00-20 12-24.5	12
12.00-24	12

Heavy Trucks

- Light weight for easy handling
- Deep hardened 6mm side chain and 8mm hook



Tire Size	Cross link
10.00-22 11-24.5 295/75-24.5	10
11.00-20 12R-22.5 295/80-22.5	11
11.00-22 12.00-20 12-24.5	12
12.00-24	12

Heavy Trucks

Heavy & Powerfull

9.5mm(3/8") crossers, 11mm(7/16") studs

8mm (5/16") side chain, 11mm(7/16") hooks



Tire Size	Cross link
11R-24.5	8
12R-22.5 11.00-20	9
12R-24.5 12.00-20	9
12.00-24	10
14.00-20	13
14.00-24	13

Compact Tractor & ATV

Diamond pattern stays on top of lugs for continious grip

Studs on every second link increase ground penetration

Low profile, needs only 1-1/2" side wall clearance and 2" for fender clearance

5.5mm & 6mm crossers chain

6.6mm round studs

5mm side chain



Tire Size
16*8-7
16*6.5-8 170/60-8
5.00-12 5.00-10
18*8.5-8 18*8.5-10
205/80-12
20*10-8 20*9-8 20*8-8 20*8-10
23*8.0-12 23*8.5-12 23*8.5-14
23*10.5-12 23*10.0-10 24*9-11
24*8.5-14 24*9.0-12 25*8.0-12
220/55-12
24*10.5-12 25*10.0-12 25*10.0-10
26*8.0-12 24*8-12 26*8.0-14 24*8.5-12
205/65-15 205/85-12 23*10.5-12
26*9-12 25*8.5-14
6.00-12 6.00-14
24*10.00-11 24*11.00-10 24*11.5-10
25*10.00-10 25*10.00-12 25*11.00-10
26*10.50-12 25*10.50-12 25*12-*
25*11.00-10 25*12.5-12 26*10.5-12
26*11.00-14
11.0/65-12 25*12.5-10 25*12.5-12
26*10.00-12 26*10.50-12 26*11.00-12
26*12.00-12 27*9.00-12 27*12.00-12
27*9.00-14 27*11.00-14 255/60-14
28*12.00-12 27*12.00-12
27*8.5-15
7.00-16 8.00-16
27*10.5-15 27*9.5-15 7.00-12 7.00-14
30*9.00-14 28*8.5-14
27*12.5-15 29*12.5-15 31*12.5-15
12-16.5 33*12.5-15
7.50-18 8.00-18 8.3-22 8.3-24
11.2-16 12.4-16 13.6-16

Farm Tractors

Off road grip and traction for farm tractors working in the woods and steep terrain

Tight mesh pattern keeps many studs in contact with the ground at all times

Multi-fit design easily adjusts to fit perfectly on new and used tires with no tools required

Alloy steel deep case hardened for strength, durability and long service life



8mm chain					
#802901	#802902	#802903	#802904	#802905	#802906
12.4-28	11.2-24	13.6-24	12.4-20	8.00-20	10.5-20
12.4-32	11.2-28	14.9-24	12.5-20	8.25-20	11.2-20
13.6-28	12.4-24	360/70-24	13.6-16	8.3-24	12.5/80-18
320/85-28	280/85-24	380/70-24	14.5-20	9.5-20	12.5/80-20
340/85-24	320/70324	380/85-24	15-19.5	9.5-24	260/80-20
	320/85-24	400/60-26.5	14/80-20	210/85-29	280/70-20
		400/80-24	41*1400-20	240/85-24	300/70-20
		425/75-20	300/70-24	240/85-20	320/70-20
		14.00-20	320/70-24	250/80-18	
			340/75-20		
			360/70-20		
			365/80-20		
#802907	#802908	#802909	#802910	#802911	
16/70-20	10.0/75-15.3	12.5-18	440/65-28	17.5-25	
360/70-20	10.5/70-15.5	14.0/65-16	420/70-24	19.5L-24	
365/80-20	280/60-16.5	15.0/55-17	460/70-24	480/65-28	
375/75-20	10-16.5	15.5/55-18	400/80-24	480/70-24	
380/70-20	12-16.5	15.5/65-18	440/65-26.5	440/80-24	
405/70-18		335/80-18	440/70-24	495/70-24	
405/70-20		340/65-18	445/70-24	520/65-24	
43*1600-20		365/70-18	405/70-24	480/65-24	
		38*1400-20	460/65-24		
		12.4-16	440/65-24		
		31*15.5-15	420/65-24		
		38*1400-20	16.0/70-24		
		400/65-15.5	425/65-22.5		
			445/65-22.5		

9.5mm chain					
#903901	#903902	#903903	#903904	#903905	#903906
14.9-38	16.9-38	13.00-24/25	12.4-36	16.0/70-24	14.00-24/25
15.5-38	18.4-30	13.6-28	12.4-38	400/80-24	14.9-28
16.00-24/25	18.4-34	14.00-20	13.6-36	405/70-24	14.9-30
16.9-28	420/85-34	14.9-24	13.6-38	420/65-24	16.9-24
16.9-30	460/85-30	14.9-28		420/70-24	16.9-26
26.9-34	460/85-34	15.5-25		440/65-24	380/85-28
18.4-30	480/70-34	380/70-28		440/65-26.5	380/85-30
420/70-34	480/70-38	380/85-24		440/65-28	420/70-28
420/85-28		380/85-28		440/70-24	420/70-30
420/85-30				445/70-24	420/85-24
440/80-28				455/70-20	
460/85-30					
#903907	#903908	#903909	#903910	#903911	
13.6-24	20.5-25	18.4-38	12.4-24	17.5-25	
14.5-20	480/70-30	460/85-30	12.4-28	19.5L-24	
14.9-20	480/70-34	480/70-38	13.6-24	440/80-24	
14/80-20	520/70-30	520/70-34	320/85-24	480/65-24	
340/85-24	540/65-30	520/70-38		480/65-28	
360/70-24	540/65-34	540/65-38		480/70-24	
365/80-20		600/65-34		495/70-24	
375/75-20				520/65-24	
380/70-24					
400/70-18					
405/70-18					

Aggressive all purpose chain for all types of off road conditions

Twisted links keep the studs vertical a all times

Tight mesh pattern stays on top of the tire lugs for maximum stud penetration

Alloy steel deep case hardened ensures durability and long service life

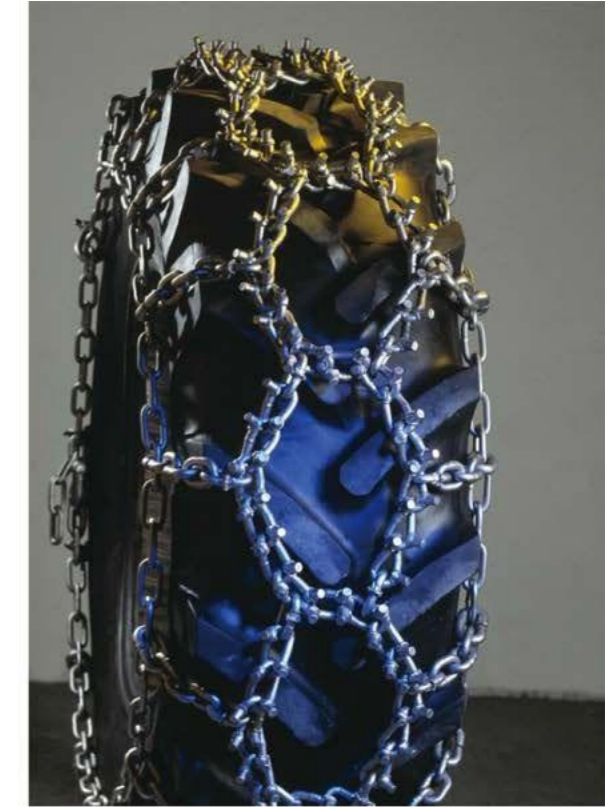

SKIDDER TIRES	CHAIN SIZE
16.9-30 18.4-26	13MM 16MM
26.9-34 18.4-30	13MM 16MM
18.4-34 23.1-26	13MM 16MM 19MM
24.5-32 28 L 26 23.5-25	16MM 19MM
30.5-32 29.5-25 26.5-25 L5	16MM 19MM
35.5-32	19MM

EQUIPMENT TIRES	CHAIN SIZE
14.00-24/25	
16.00-24/25	9.5MM
18.00-24/25	
17.5-25	11MM
20.5-25	
20.5-25 L5	13MM
23.5-25	
23.5-25 L5	16MM
26.5-25	
26.5-25 L5	
29.5-25	
29.5-25 L5	

Extreme grip stability from massive amount of studs gripping the terrain at all times

Tight mesh coverage protects tires from wear and damage

Performs extremely well on steep icy terrain

Deep case hardened alloy steel ensures durability and long service life



LOADERS	GAUGE	FORWARDERS	GAUGE	SKIDDERS	GAUGE
20.5-25	11MM	600/50-22.5	11MM	18.4-24	13MM
23.5-25	13MM	600/55-26.5	13MM	18.4-34	16MM
23.5-25	16MM	600/60-30.5	11MM	23.1-26	13MM
26.5-25	13MM	600/65-38	11MM	23.1-26	16MM
26.5-25	16MM	650/65-38	11MM	23.1-26	19MM
		700/50-26.5	13MM	24.5-32	16MM
		700/50-26.5	16MM	24.5-32	19MM
		700/55-34	13MM	30.5-32	16MM
		710/55-26.5	13MM	30.5-32	19MM
		750/55-26.5	13MM	35.5-32	19MM
		750/55-26.5	16MM		

BIG RINGS SKIDDER CHAIN & NET STUDDED SKIDDER CHAINS



FIXED RING CHAIN



TIGHT RINGS CHAIN



MULTIRING RING CHAIN



DOUBLE RINGS CHAIN



FLOATING RING CHAIN

Customized skidder chain are available

BIG RINGS SKIDDER CHAIN & NET STUDDED SKIDDER CHAINS

U-Grip



- Combination between maximum grip under mount U-stud links and resistant drop forged parts
- Double or triple diamond configurations
- Ultimate stability and traction
- Extremely resistant to wear and breakages
- For most demanding forestry environment
- Available in 16mm, 18mm and 20mm material sizes
- Suitable tire sizes: 23.1×26, 30.5×32, 35.5×32, 73×44×32

U type chain

- Double diamond configuration
- Top mounted U studs
- Prevent chain from rolling
- Ensure continual traction
- Easy to fit and remove
- Available in 19mm chain and 20mm U studs
- Suitable tire sizes: 30.5×32, 35.5×32



Double Link Chain

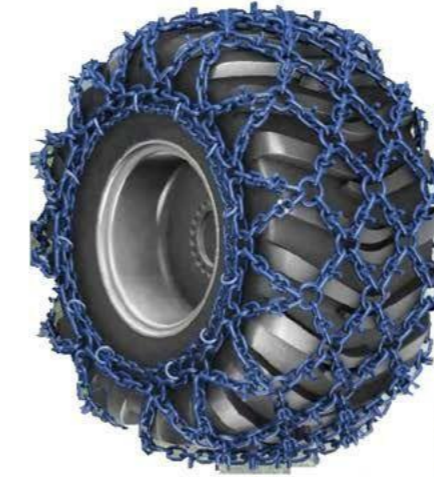

C Type Chain

- Double or triple diamond configurations
- High grip and durability in icy or rocky conditions
- Extremely resistant to wear and breakages
- Available in 16mm, 18mm and 22mm material sizes
- Suitable tire sizes: 23.1×26, 24.5×32, 30.5×32, 35.5×32, 73×44×32



II Type Chain

BIG RINGS SKIDDER CHAIN & NET STUDDED SKIDDER CHAINS

FORESTRY PARTS



CHOKER CHAIN	
ART. NO.	DESCRIPTION
2-1010006	G80 ROUND CHAIN WITH FOREST HOOK AND ROD - 6MM
2-1010007	G80 ROUND CHAIN WITH FOREST HOOK AND ROD - 7MM
2-1010008	G80 ROUND CHAIN WITH FOREST HOOK AND ROD - 8MM
2-1010010	G80 ROUND CHAIN WITH FOREST HOOK AND ROD - 10MM
2-1020008	G80 SQUARE CHAIN WITH FOREST HOOK AND ROD - 8MM
2-1030006	G100 ROUND CHAIN WITH FOREST HOOK AND ROD - 6MM
2-1031008	G100 ROUND CHAIN WITH FOREST HOOK AND ROD - 8MM



CHAIN WITH FOREST HOOK AND CLEVIS GRAB HOOK EACH END	
ART. NO.	DESCRIPTION
3-1010006	G80 ROUND CHAIN WITH FOREST AND GRAB HOOK - 6MM
3-1010007	G80 ROUND CHAIN WITH FOREST AND GRAB HOOK - 7MM
3-1010008	G80 ROUND CHAIN WITH FOREST AND GRAB HOOK - 8MM
3-1010010	G80 ROUND CHAIN WITH FOREST AND GRAB HOOK - 10MM
3-1030006	G100 ROUND CHAIN WITH FOREST AND GRAB HOOK - 6MM
3-1031008	G100 ROUND CHAIN WITH FOREST AND GRAB HOOK - 8MM



ART. NO.	DESCRIPTION
5-1010006	G80 CLEVIS FOREST HOOK - 6MM
5-1010007	G80 CLEVIS FOREST HOOK - 7/8MM
5-1010008	G80 CLEVIS FOREST HOOK - 7/8MM
5-1010010	G80 CLEVIS FOREST HOOK - 10MM

ART. NO.	DESCRIPTION
6-1012008	CHAIN-ROPE CONNECTOR
6-1013006	SWIVEL CONNECTOR - 6MM
6-1013008	SWIVEL CONNECTOR - 8MM
6-1010006	G80 CONNECTING LINK 6MM
6-1010008	G80 CONNECTING LINK 8MM
6-1010010	G80 CONNECTING LINK 10MM



ROUND SLING, EN1492-2	
ART. NO.	DESCRIPTION
8-1020015	ROUND SLING 2T -1.5M
8-1020020	ROUND SLING 2T -2.0M
8-1020030	ROUND SLING 2T -3.0M
8-1030020	ROUND SLING 3T -2.0M
8-1030030	ROUND SLING 3T -3.0M
8-1030040	ROUND SLING 3T -4.0M
8-1040020	ROUND SLING 4T -2.0M
8-1040030	ROUND SLING 4T -3.0M
8-1040040	ROUND SLING 4T -4.0M